



**DEPARTMENT OF TECHNOLOGY, MANAGEMENT AND BUDGET**  
**State Facilities Administration**  
**Design and Construction Division**

## CONSTRUCTION BID ADDENDUM NO. 3

This form identifies an Addendum to Bidding Documents, and incorporates interpretations or clarifications, modifications, acceptance of proposed “or equal” materials, and other information into the Bidding Documents. Addenda will be numbered by the Professional and distributed through [www.michigan.gov/SIGMAVSS](http://www.michigan.gov/SIGMAVSS) as an attachment.

TO: <b>ALL BIDDERS</b>		DATE ISSUED 2/18/2025
PROJECT NAME Cadillac Place 15th Floor- Build (3) Judicial Suites		FILE NUMBER 950/22357.MNB
PROFESSIONAL G.H Forbes	PROJECT DIRECTOR Chris Bahjet	BID OPENING DATE: <a href="#">2/26/2025</a>

ADDENDUM ITEMS:

### 1. REFER TO ATTACHED QUESTION AND ANSWER SHEET BY FORBES

Click or tap here to enter text.

**ACKNOWLEDGEMENT:** This Addendum must be acknowledged by the Bidder in the space provided in the Bid Summary and Bid Form. Failing to acknowledge Addenda may be cause for the Bid to be rejected. Addenda will become part of the Contract Documents.

PROFESSIONAL:	DATE: Click to enter date
APPROVED BY:	
PROJECT DIRECTOR:	DATE: Click to enter date

### ADDENDUM NO. 3

Project: **Cadillac Place 15<sup>th</sup> Floor – Build Three (3) Judicial Suites**  
Location: 3044 W. Grand Blvd, Detroit, MI 48202  
File No: 950\_22357.MNB  
A/E File #: 2211  
Date: 2/18/2024

---

1. **Question:** Specification Section 26 57 00, Luminaire Product Data, is listed in the Specification Index but is not in the spec.
  - a. **Answer:** Refer to attached specification section 26 57 00 Luminaire Product Data.



## FEATURES & SPECIFICATIONS

**INTENDED USE** — Available in 2x2 and 2x4 configuration, STACK provides both functionality and efficiency. STACK is the ideal choice for many recessed commercial applications. The wide center basked and curved matte reflector allow STACK to deliver a high quality of light while maintaining optimal performance.

- **Less than 2" in depth.**
- A high level of configurability allows you to choose the perfect solution for your space.
- Available 0-10v dimming to 1%
- Long-life LEDs deliver 80% lumen maintenance at 60,000 hours

The STACK lay-in delivers low glare, ambient lighting in a popular center-basket design. A typically configured STAK features a **Unified Glare Rating (UGR)** starting at 16, UGR data available on [page 6](#). The slim profile of the luminaire, coupled with energy-saving LED technology make STACK an ideal choice for renovation or new construction. The STACK lay-in offers a high-quality, cost-effective LED lighting solution for schools, offices, retail, healthcare facilities and other commercial spaces.

**CONSTRUCTION** — The reflector is finished with a glare reducing matte white paint for improved aesthetics and increased light diffusion. End plates contain easy-to-position clips allowing the luminaire to be securely attached to the T grid. Diffusers are extruded from impact modified acrylic for increased durability. LED boards are accessible from the room-side, and drivers are accessible from the plenum.

**Integrated Sensor (nLight™ Wired Networking):** This sensor is nLight-enabled, meaning it has the ability to communicate over an nLight network. When wired, using CAT-5 cabling, with other nLight-enabled sensors, power packs, or WallPods, an nLight control zone is created. Once linked to a Gateway, directly or via a Bridge, the zone becomes capable of remote status monitoring and control via SensorView software.

**Integrated Smart Sensor (nLight Air Wireless Platform):** The RES7 sensor is nLight AIR enabled, meaning it has the ability to communicate over the wireless nLight control platform. It is available with an automatic dimming photocell, and either a digital PIR or a microphonics (PDT) dual technology occupancy sensor. It pairs to other luminaires and wall switches through our mobile app, CLAIRITY+, which allows for simple sensor adjustment

**Integrated Wireless Sensor (single room control):** Sensor Switch™ VERTEX JOT or JOTVIX15 luminaire-embedded occupancy and ambient light sensor allows the luminaire to power off when the space is unoccupied or when enough ambient light is entering the space. See page 7 for more details on the integrated wireless sensor.

**INSTALLATION** — With a depth of only 1.9", STACK makes for an easy installation, especially in restrictive plenum applications. STACK fits into standard 15/16" and narrow 9/16" T-grid ceiling systems. Suitable for damp location.

**ELECTRICAL** — Long-life LED's, coupled with high-efficiency drivers provide superior quality of light and an extended service life. 80% LED lumen maintenance at 60,000 hours (L80/60,000). 0-10 volt dimming driver, dims to 1%.

**OPTICS** — Volumetric illumination is achieved by creating an optimal mix of light to walls, partitions and vertical and horizontal work surfaces – rendering the interior space, objects and occupants in a more balanced, complimentary luminous environment. A high performance acrylic diffuser conceals LED's and efficiently delivers light in a volumetric distribution.

**LISTINGS** — CSA certified to meet US and Canadian standards. Damp location listed. IC rated. DesignLights Consortium® (DLC) Premium qualified product and DLC qualified product. Not all versions of this product may be DLC Premium qualified or DLC qualified. Please check the DLC Qualified Products List at [www.designlights.org/QPL](http://www.designlights.org/QPL) to confirm which versions are qualified.

**WARRANTY** — 5-year limited warranty. This is the only warranty provided and no other statements in this specification sheet create any warranty of any kind. All other express and implied warranties are disclaimed. Complete warranty terms located at: [www.acuitybrands.com/support/warranty/terms-and-conditions](http://www.acuitybrands.com/support/warranty/terms-and-conditions)

**Note:** Actual performance may differ as a result of end-user environment and application. All values are design or typical values, measured under laboratory conditions at 25 °C. Specifications subject to change without notice

Catalog Number	
Notes	
Type	L1

### LED Center Element Lay-In

# STACK



#### Specifications

Length 2X2: 23-3/4 (60.3)

Length 2X4: 47-3/4 (121.2)

Width: 23-3/4 (60.3)

Depth: 1.9 (4.8)

All dimensions are inches (centimeters) unless otherwise specified.



L1

**STACK** LED Center Element Troffer

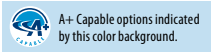

**ORDERING INFORMATION**

Lead times will vary depending on options selected. Consult with your sales representative.

**Example:** STAK 2X4 5000LM 80CRI 40K COL MIN10 ZT MVOLT

Series	Size	Lumens	CRI	Color Temperature	Lens	Minimum Dimming	Dimming ‡	Voltage
STAK	1X4 1'x4' ‡	3000LM	80CRI 80 CRI	30K 3000K	COL Curved Opal Lens	MIN1 Dims to 1% ‡	(blank) none	MVOLT 120-277V
		4000LM	90CRI 90 CRI	35K 3500K	COLT Curved Opal Lens with Trim	MIN10 Dims to 10%	EZT eldoLED 0-10V Dimming ‡	120 120V
		5000LM		40K 4000K		ZT Generic 0-10V Dimming	277 277V	
	6000LM		50K 5000K			347 347V ‡		
	2X4 2'x4'	3000LM						
		4000LM						
		5000LM						
	2X2 2'x2'	2000LM						
		3000LM						
4000LM								
		5000LM						

Step Level Dimming Option	Emergency Options	Controls Input	Sensor
SLD Step-level dimming ‡	E7W EM battery pack, 7W, CA Title 20 Noncompliant ‡ E10WLCP EM Self-Diagnostic battery pack, 10W Constant Power, Certified in CA Title 20 MAEDBS ‡ E15WLCP EM Self-Diagnostic battery pack, 15W Constant Power, Certified in CA Title 20 MAEDBS ‡ GTD Generator Transfer Device ‡	(blank) No Control Input SSE Sensor Switch Embedded	(blank) No Sensor or Control Input function only, if selected. APIR Occ sensing with passive infrared - on/off functionality and auto dimming photocell APDT Occ sensor dual tech (passive infrared & microphonics) and auto dimming photocell VPIR8 Vertex low-profile on/off occupancy PIR occupancy sensor with VLP programming at 8ft mounting height VAPIR8 Vertex low-profile on/off occupancy sensor with auto dimming photocell with VLP programming at 8ft mounting height VPIR15 Vertex low-profile on/off occupancy PIR occupancy sensor with VLP programming at 15ft mounting height VAPIR15 Vertex low-profile on/off occupancy sensor with auto dimming photocell with VLP programming at 15ft mounting height
		NLIGHT nLight enabled NLIGHTER nLight enabled, for use with generator supply EM power NLIGHTLM nLight enabled with lumen management NLIGHTERLM nLight enabled with lumen management, for use with generator supply EM power	(blank) No sensor, Control Input function only PIR Occ sensing with passive infrared - on/off functionality PDT Occ sensor dual tech (passive infrared & microphonics) APIR Occ sensing with passive infrared - on/off functionality and auto dimming photocell APDT Occ sensor dual tech (passive infrared & microphonics) and auto dimming photocell VPIR8 Vertex low-profile on/off occupancy PIR occupancy sensor with VLP programming at 8ft mounting height
		NLTAIR2 nLight AIR Generation 2 (wireless) enabled ‡ NLTAIREM2 nLight AIR Generation 2 (wireless) enabled and UL924 Emergency Operation, via power interrupt detection ‡	(blank) No sensor, Control Input function only APIR Occ sensing with passive infrared - on/off functionality and auto dimming photocell APDT Occ sensor dual tech (passive infrared & microphonics) and auto dimming photocell APIREM Occ sensing with passive infrared - on/off functionality and auto dimming photocell and UL924 Emergency Operation, via power interrupt detection APDTEM Occ sensor dual tech (passive infrared & microphonics) and auto dimming photocell and UL924 Emergency Operation, via power interrupt detection. VPIR8 Vertex low-profile on/off occupancy PIR occupancy sensor with VLP programming at 8ft mounting height
		JOT JOT, "Just One Touch" (wireless) enabled	(blank) No sensor, Control Input function only VAPIR15 Vertex low-profile on/off occupancy sensor with auto dimming photocell with VLP programming at 15ft mounting height



STACK

L1

**STACK LED Center Element Troffer**

Standby Mode	Options																
NOC Occupancy Sensor Disabled	<table border="0"> <tr> <td>PWS1836</td> <td>6' pre-wire, 3/8" diameter, 18 gauge, 1 circuit</td> <td>CP</td> <td>Chicago Plenum ‡</td> </tr> <tr> <td>PWS1846</td> <td>6' pre-wire, 3/8" diameter, 18 gauge, 2 circuit</td> <td>LATC</td> <td>T-bar clips</td> </tr> <tr> <td>PWS1846 PWSLV</td> <td>Two cables: one 6' pre-wire, 3/8" diameter, 18 gauge, 2 circuits; one 6' pre-wire, 3/8" diameter, 18 gauge ‡</td> <td>DWAM</td> <td>Anti-microbial paint</td> </tr> <tr> <td>PWS1856LV</td> <td>6' pre-wire, 3/8" diameter, 18 gauge, 1 circuit w/low voltage wires ‡</td> <td></td> <td></td> </tr> </table>	PWS1836	6' pre-wire, 3/8" diameter, 18 gauge, 1 circuit	CP	Chicago Plenum ‡	PWS1846	6' pre-wire, 3/8" diameter, 18 gauge, 2 circuit	LATC	T-bar clips	PWS1846 PWSLV	Two cables: one 6' pre-wire, 3/8" diameter, 18 gauge, 2 circuits; one 6' pre-wire, 3/8" diameter, 18 gauge ‡	DWAM	Anti-microbial paint	PWS1856LV	6' pre-wire, 3/8" diameter, 18 gauge, 1 circuit w/low voltage wires ‡		
PWS1836	6' pre-wire, 3/8" diameter, 18 gauge, 1 circuit	CP	Chicago Plenum ‡														
PWS1846	6' pre-wire, 3/8" diameter, 18 gauge, 2 circuit	LATC	T-bar clips														
PWS1846 PWSLV	Two cables: one 6' pre-wire, 3/8" diameter, 18 gauge, 2 circuits; one 6' pre-wire, 3/8" diameter, 18 gauge ‡	DWAM	Anti-microbial paint														
PWS1856LV	6' pre-wire, 3/8" diameter, 18 gauge, 1 circuit w/low voltage wires ‡																

‡ Option Value Ordering Restrictions	
Option Value	Restriction
1X4	Not available with sensors (PIR, PDT, APIR, APDT, APIREM, APDTEM, VPIR8, VAPIR8, VPIR15, VAPIR15) at this time
MIN1	Required for all Control Input options, excluding JOT. Not available with SLD.
Dimming	This section is left blank only when a Control Input option or Step Level Dimming option is selected
EZT	Not available with MIN10
347	Not available with: E7W, E10WLCP, E15WLCP, SLD, GTD
SLD	Not available with controls. Must select MIN10. Leave Dimming section blank
E7W, E10WLCP	Not available with 347V
E15WLCP	Not available with: 2X2 or 347V
GTD	Must select 120 OR 277. Not available with 347V or MVOLT
SSE	Not available with size 1X4
NLTAIR2	See UL924 Sequence of Operation chart on page 3. Can be used as a normal power sensing device for nLight AIR devices and luminaires with EM emergency options.
NLTAIREM2	See UL924 Sequence of Operation Chart on page 3. Leave sensor option blank, not available with APIR, APDT, APIREM, APDTEM or VPIR8.
NLIGHT, NLIGHTER, NLIGHTLM, NLIGHTERLM	Not available with size 1X4 when combined with sensor options.
JOT	Not available with size 1X4, SLD, nLight, NLTAIR2, NOC, or GTD options. Must be ordered with COLT, not available with COL.
NOC	Must select a Wireless Network Control
PWS1846 PWSLV, PWS1856LV	Not available with nLight wired network or individual controls
CP	Not available with Wired Network Controls, PWS1836, PWS1846, PWS1846 PWSLV or PWS1856LV.

**ACCESSORIES**

Accessories: Order as separate catalog number.	
DGA24	Drywall grid adapter for 2x4 recessed fixture.
DGA22	Drywall grid adapter for 2x2 recessed fixture.
2X4SMKSH PAF	Multi-Use Surface Mount Kit 2X4 Post-Paint
2X2SMKSH PAF	Multi-Use Surface Mount Kit 2X2 Post-Paint
ILB CP10 A	LED emergency battery pack, 10W 50VDC (Noncompliant with CA T20)
ILBLP CP10 HE SD A	LED emergency battery pack, 10W Constant Power, Self-Diagnostic, Certified in CA Title 20 MAEDBS
ELA PSRME IC	Remote enclosure for battery for insulated ceiling
RK8BDP 2P U	Disconnect Plug (BDP), 2 Pole, Package of 1
RK8BDP 3P U	Disconnect Plug (BDP), 3 Pole, Package of 1
RK8BDP 2P J10	Disconnect Plug (BDP), 2 Pole, Package of 10
RK8BDP 2P J40	Disconnect Plug (BDP), 2 Pole, Package of 40

**UL924 Sequence of Operation**

The below information applies to all nLight AIR devices with an EM option.

- EM devices will remain at their high-end trim and ignore wireless lighting control commands, unless a normal-power-sensed (NPS) broadcast is received at least every 8 seconds.
- Using the CLAIRITY+ mobile app, EM devices must be associated with a group that includes a normal power sensing device to receive NPS broadcasts.
- Only non-emergency rPP20, rLSXR, rSBOR, rSDGR, and nLight AIR luminaires with version 3.4 or later firmware can provide normal power sensing for EM devices. See specification sheets for control devices and luminaires for more information on options that support normal power sensing.

STACK is compatible with Sensor Switch™  
WSXA D and SPODMA D as well as nLight Wall Pods.



WSXA D



SPODMA D



nLight WIRED  
nPODMA DX



nLight AIR  
rPODBA



STACK

L1

**STACK** LED Center Element Troffer

**Intelligent Luminaire Technology Guide**

Choose nomenclature from these columns			Sensor	Notes	Previous Nomenclature
Control/Sensor Configurations	Control Input	Sensor	Sensor	Notes	Previous Nomenclature
	SSE +	APIR =	MSD 7 ADCX	Individual fixture control only. PIR integral occupancy sensor with automatic dimming control photocell.	MSD7ADCX
	SSE +	APDT =	MSD PDT 7 ADCX	Individual fixture control only. PDT integral occupancy sensor with automatic dimming control photocell.	MSDPDT7ADCX
	SSE +	VPIR8 =	VERTEX 8F EZ OCC VLP	Vertex low-profile on/off occupancy PIR occupancy sensor with VLP programming at 8ft mounting height.	VTX8FOCC
	SSE +	VAPIR8 =	VERTEX 8F EZ ADC VLP	Vertex low-profile on/off occupancy sensor with auto dimming photocell with VLP programming at 8ft mounting height.	VTX8FADC
	SSE +	VPIR15 =	VERTEX 15F EZ OCC VLP	Vertex low-profile on/off occupancy PIR occupancy sensor with VLP programming at 15ft mounting height.	VTX15FOCC
	SSE +	VAPIR15 =	VERTEX 15F EZ ADC VLP	Vertex low-profile on/off occupancy sensor with auto dimming photocell with VLP programming at 15ft mounting height.	VTX15FADC
	JOT +	(blank) =	BTRM JOT BTA	Wireless room control with "Just One Touch" pairing.	JOT
	JOT +	VAPIR15 =	BTRM JOT BTA + VERTEX 15F EZ ADC VLP GSKT	Wireless room control with "Just One Touch" pairing.	JOTVTX15
	NLIGHT +	(blank) =	nIO EZDXA	nLight enabled only. No onboard sensor.	NLIGHT
	NLIGHT +	PIR =	nIO EZDCL + nES 7	nLight enabled with PIR integral occupancy sensor.	NLIGHT NES7
	NLIGHT +	PDT =	nIO EZDCL + nES PDT 7	nLight enabled with dual technology occupancy control sensor.	NLIGHT NESPDT7
	NLIGHT +	APIR =	nIO EZDCL + nES 7 ADCX	nLight enabled with PIR integral occupancy sensor with automatic dimming photocell.	NLIGHT NES7ADCX
	NLIGHT +	APDT =	nIO EZDCL + nES PDT 7 ADCX	nLight enabled with dual technology occupancy controls sensor with automatic dimming photocell.	NLIGHT NESPDT7ADCX
	NLIGHT +	VPIR8 =	nIO EZDXA + VERTEX 8F EZ OCC VLP	nLight enabled with Vertex low-profile on/off occupancy PIR occupancy sensor with VLP programming at 8ft mounting height.	NLIGHT NVTX8FOCC
	NLIGHTER +	(blank) =	nIO EZDCL ER	Emergency nLight enabled only. No onboard sensor.	NLIGHT EMG
	NLIGHTER +	PIR =	nIO EZDCL ER PH + nES 7	Emergency nLight enabled with PIR integral occupancy sensor.	NLIGHT EMG NESPDT7
	NLIGHTER +	PDT =	nIO EZDCL ER PH + nES PDT 7	Emergency nLight enabled with dual technology occupancy control sensor.	NLIGHT EMG NES7ADC
	NLIGHTER +	APIR =	nIO EZDCL ER + nES 7 ADCX	Emergency nLight enabled with PIR integral occupancy sensor with automatic dimming photocell.	NLIGHT EMG NES7ADCX
	NLIGHTER +	APDT =	nIO EZDCL ER + nES PDT 7 ADCX	Emergency nLight enabled with dual technology occupancy controls sensor with automatic dimming photocell.	NLIGHT EMG NESPDT7ADCX
	NLIGHTLM +	(blank) =	nIO EZDCL N80	nLight enabled only with 80% constant lumen management. No onboard sensor.	NLIGHT CL80
	NLIGHTLM +	PIR =	nIO EZDCL N80 + nES 7	nLight enabled with 80% constant lumen management with PIR integral occupancy sensor.	NLIGHT CL80 NES7
	NLIGHTLM +	PDT =	nIO EZDCL N80 + nES PDT 7	nLight enabled with 80% constant lumen management with dual technology occupancy control sensor.	NLIGHT CL80 NESPDT7
	NLIGHTLM +	APIR =	nIO EZDCL N80 + nES 7 ADCX	nLight enabled with 80% constant lumen management with PIR integral occupancy sensor with automatic dimming photocell.	NLIGHT CL80 NES7ADCX
	NLIGHTLM +	APDT =	nIO EZDCL N80 + nES PDT 7 ADCX	nLight enabled with 80% constant lumen management with dual technology occupancy controls sensor with automatic dimming photocell.	NLIGHT CL80 NESPDT7ADCX
	NLIGHTLMER +	(blank) =	nIO EZDCL ER N80	Emergency nLight enabled only with 80% constant lumen management. No onboard sensor.	NLIGHT EMG CL80
	NLIGHTLMER +	PIR =	nIO EZDCL ER N80 + nES 7	Emergency nLight enabled with 80% constant lumen management with PIR integral occupancy sensor.	NLIGHT EMG CL80 NES7
	NLIGHTLMER +	PDT =	nIO EZDCL ER N80 + nES PDT 7	Emergency nLight enabled with 80% constant lumen management with dual technology occupancy control sensor.	NLIGHT EMG CL80 NESPDT7
	NLIGHTLMER +	APIR =	nIO EZDCL ER N80 + nES 7 ADCX	Emergency nLight enabled with 80% constant lumen management with PIR integral occupancy sensor with automatic dimming photocell.	NLIGHT EMG CL80 NES7ADCX
	NLIGHTLMER +	APDT =	nIO EZDCL ER N80 + nES PDT 7 ADCX	Emergency nLight enabled with 80% constant lumen management with dual technology occupancy controls sensor with automatic dimming photocell.	NLIGHT EMG CL80 NESPDT7ADCX
	NLTAIR2 +	(blank) =	RIO EZDL 180D G2	nLight AIR Generation 2 enabled.	NLTAIR2 RIO
	NLTAIR2 +	(blank) =	RIO EZDL EM 180D G2	nLight AIR Generation 2 enabled.	NLTAIR2 RIOEM
	NLTAIR2 +	APIR =	RES7 G2	nLight AIR Generation 2 enabled.	NLTAIR2 RES7
	NLTAIR2 +	APDT =	RES7 PDT 90D G2	nLight AIR Generation 2 enabled.	NLTAIR2 RES7PDT
	NLTAIR2 +	APIREM =	RES7 EM 90D G2	nLight AIR Generation 2 enabled.	NLTAIR2 RES7EM
	NLTAIR2 +	APDTEM =	RES7 PDT EM 90D G2	nLight AIR Generation 2 enabled.	NLTAIR2 RES7PDTEM
	NLTAIR2 +	VPIR8 =	RIO EZDL EXTDB ACWV 90D G2 + VERTEX 8F EZ OCC VLP	nLight AIR Generation 2 enabled. Vertex low-profile on/off occupancy PIR occupancy sensor with VLP programming at 8ft mounting height.	NLTAIR2 RVT8FOCC



STACK

L1

## STACK LED Center Element Troffer

### nLight Platform

#### nLight AIR Wireless

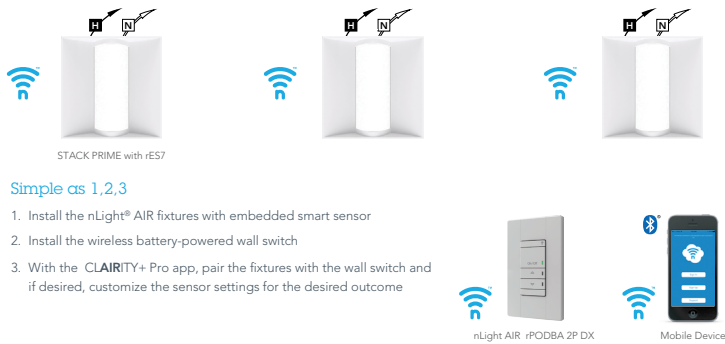

#### Simple as 1,2,3

1. Install the nLight® AIR fixtures with embedded smart sensor
2. Install the wireless battery-powered wall switch
3. With the CLAIRITY+ Pro app, pair the fixtures with the wall switch and if desired, customize the sensor settings for the desired outcome

#### nLight Wired Networking

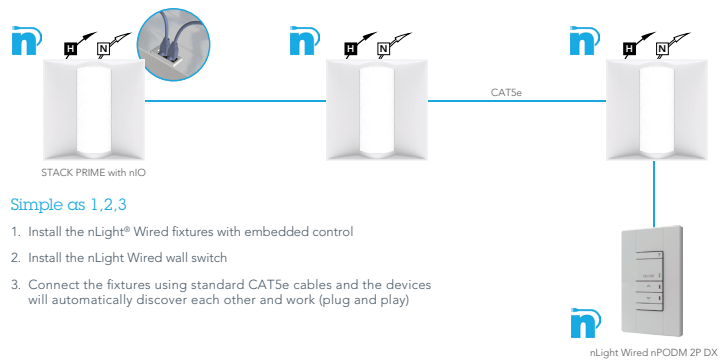

#### Simple as 1,2,3

1. Install the nLight® Wired fixtures with embedded control
2. Install the nLight Wired wall switch
3. Connect the fixtures using standard CAT5e cables and the devices will automatically discover each other and work (plug and play)

nLight embedded fixtures offer:	Customers get:
Manual Dimming	Convenience and visual comfort for occupants
Motion Sensing and/or Daylight Harvesting	Energy savings and code compliance
Fixture or Group Level Control	Ability to configure lighting to the space requirements
Flexibility	Ease of fixture moves, adds and changes
Wireless Wall Switch (nLight AIR Only)	Ease and flexibility of placement
Astronomical and Time of Day Scheduling	Energy savings and building security
Scalable Solution	nLight controls to grow with your business
Future-Ready	nLight platform to set foundation for future upgrades and capabilities

L1

## STACK LED Center Element Troffer

### Controls Accessories

nLight® Wired Control Accessories: <i>Order as separate catalog number. Visit <a href="http://www.acuitybrands.com/products/controls/nlight">www.acuitybrands.com/products/controls/nlight</a>.</i>			
<b>WallPod stations</b>	<b>Model number</b>	<b>Occupancy sensors</b>	<b>Model number</b>
On/Off	nPODMA [Color]	Small motion 360°, ceiling (PIR / dual tech)	nCM 9 RJB / nCM PDT 9 RJB
On/Off & raise/lower	nPODMA DX [Color]	Large motion 360°, ceiling (PIR / dual tech)	nCM10 RJB / nCM PDT 10 RJB
Graphic touchscreen	nPOD TOUCH [Color]	Wall switch with raise/lower	nWSX PDT LV DX [color]
<b>Photocell controls</b>	<b>Model number</b>	<b>Cat-5 cable (plenum rated)</b>	<b>Model number</b>
Full range dimming	nCM ADCX RJB	10' cable	CATS 10FT J1
		30' cable	CATS 30FT J1

nLight® AIR Control Accessories: <i>Order as separate catalog number. Visit <a href="http://www.acuitybrands.com/products/controls/nlightair">www.acuitybrands.com/products/controls/nlightair</a>.</i>	
<b>Wall switches</b>	<b>Model number</b>
On/Off single pole	rPODBA [color] G2
On/Off two pole	rPODB A2P [color] G2
On/Off & raise/lower single pole	rPODBA DX [color] G2
On/Off & raise/lower two pole	rPODBA 2P DX [color] G2



Sensor Switch  
WSKA D



nLight WIRED  
nPOD UNITOUCH



nLight WIRED  
nPODMA DX



nLight AIR  
rPODBA

### PHOTOMETRICS

See STACK Prime - Low-Profile Recessed LED Luminaire ([acuitybrands.com](http://acuitybrands.com)) for photometry reports.

#### UGR Chart

UGR Values of STAKP 1x4 @ 80CRI and 3500K (70% 50% 20% reflectance using a 4H x 8H room size)				
Lumen Package	COL		COLT	
	Crosswise	Endwise	Crosswise	Endwise
3000LM	21.5	21.8	21.5	22.2
4000LM	22.4	22.8	23.7	24.4
5000LM	23.2	23.5	23.2	23.9
6000LM	23.6	24	22.4	23.1

UGR Values of STAKP 1x4 @ 90CRI and 3500K (70% 50% 20% reflectance using a 4H x 8H room size)				
Lumen Package	COL		COLT	
	Crosswise	Endwise	Crosswise	Endwise
3000LM	21	21.4	21.1	21.8
4000LM	21.9	22.3	22	22.7
5000LM	22.7	23.1	22.8	23.5
6000LM	23.2	23.6	23.3	23.9

UGR Values of STAKP 2x2 @ 80CRI and 3500K (70% 50% 20% reflectance using a 4H x 8H room size)				
Lumen Package	COL		COLT	
	Crosswise	Endwise	Crosswise	Endwise
2000LM	18.9	20.5	16.5	17.8
3000LM	20	21.6	17.7	19
4000LM	21	22.6	18.6	19.9
5000LM	21.7	23.4	19.4	20.7

UGR Values of STAKP 2x2 @ 90CRI and 3500K (70% 50% 20% reflectance using a 4H x 8H room size)				
Lumen Package	COL		COLT	
	Crosswise	Endwise	Crosswise	Endwise
2000LM	18.4	20	16.1	17.3
3000LM	19.6	21.2	17.3	18.5
4000LM	20.5	22.2	18.2	19.5
5000LM	21.3	22.9	19	20.2

UGR Values of STAKP 4x4 @ 80CRI and 3500K (70% 50% 20% reflectance using a 4H x 8H room size)				
Lumen Package	COL		COLT	
	Crosswise	Endwise	Crosswise	Endwise
3000LM	18	19.3	20.1	21.4
4000LM	18.9	20.2	20.7	22
5000LM	19.7	21.1	17.9	19.2
6000LM	20.2	21.5	18.8	20.1
7200LM	20.8	22.1	19.7	20.9

UGR Values of STAKP 4x4 @ 90CRI and 3500K (70% 50% 20% reflectance using a 4H x 8H room size)				
Lumen Package	COL		COLT	
	Crosswise	Endwise	Crosswise	Endwise
3000LM	19.3	20.6	19.2	20.5
4000LM	19.8	21.1	19.7	21
5000LM	20.4	21.7	20.3	21.6
6000LM	17.5	18.9	17.5	18.7
7200LM	18.5	19.8	18.4	19.6

UGR varies based on luminaire options and is affected by application dependent parameters. Numbers depicted here are considered "Luminaire-UGR and/or "Point-UGR" values. To determine a more precise maximum UGR value ("Application-UGR"), a full lighting design layout should be completed with the selected luminaire configuration for each application.



STACK



L1

**STACK** LED Center Element Troffer

**PERFORMANCE DATA**

Performance Data			
Luminaire Catalog	Lumens	Wattage	Efficacy
STAK 2X2 2000LM 80CRI 30K COL MVOLT	2,160	16.8	128.8
STAK 2X2 2000LM 80CRI 30K COLT MVOLT	2,109	16.8	125.7
STAK 2X2 2000LM 80CRI 35K COL MVOLT	2,241	16.8	133.6
STAK 2X2 2000LM 80CRI 35K COLT MVOLT	2,188	16.8	130.4
STAK 2X2 2000LM 80CRI 40K COL MVOLT	2,311	16.8	137.7
STAK 2X2 2000LM 80CRI 40K COLT MVOLT	2,257	16.8	134.5
STAK 2X2 2000LM 80CRI 50K COL MVOLT	2,311	16.8	137.7
STAK 2X2 2000LM 80CRI 50K COLT MVOLT	2,257	16.8	134.5
STAK 2X2 3000LM 80CRI 30K COL MVOLT	3,029	24.1	125.4
STAK 2X2 3000LM 80CRI 30K COLT MVOLT	2,957	24.1	122.5
STAK 2X2 3000LM 80CRI 35K COL MVOLT	3,141	24.1	130.1
STAK 2X2 3000LM 80CRI 35K COLT MVOLT	3,067	24.1	127
STAK 2X2 3000LM 80CRI 40K COL MVOLT	3,240	24.1	134.2
STAK 2X2 3000LM 80CRI 40K COLT MVOLT	3,163	24.1	131
STAK 2X2 3000LM 80CRI 50K COL MVOLT	3,240	24.1	134.2
STAK 2X2 3000LM 80CRI 50K COLT MVOLT	3,163	24.1	131
STAK 2X2 4000LM 80CRI 30K COL MVOLT	3,978	33.3	119.4
STAK 2X2 4000LM 80CRI 30K COLT MVOLT	3,884	33.3	116.6
STAK 2X2 4000LM 80CRI 35K COL MVOLT	4,126	33.3	123.8
STAK 2X2 4000LM 80CRI 35K COLT MVOLT	4,028	33.3	120.9
STAK 2X2 4000LM 80CRI 40K COL MVOLT	4,255	33.3	127.7
STAK 2X2 4000LM 80CRI 40K COLT MVOLT	4,155	33.3	124.7
STAK 2X2 4000LM 80CRI 50K COL MVOLT	4,255	33.3	127.7
STAK 2X2 4000LM 80CRI 50K COLT MVOLT	4,155	33.3	124.7
STAK 2X2 5000LM 80CRI 30K COL MVOLT	4,944	42.6	116
STAK 2X2 5000LM 80CRI 30K COLT MVOLT	4,827	42.6	113.3
STAK 2X2 5000LM 80CRI 35K COL MVOLT	5,128	42.6	120.3
STAK 2X2 5000LM 80CRI 35K COLT MVOLT	5,007	42.6	117.5
STAK 2X2 5000LM 80CRI 40K COL MVOLT	5,289	42.6	124.1
STAK 2X2 5000LM 80CRI 40K COLT MVOLT	5,164	42.6	121.2
STAK 2X2 5000LM 80CRI 50K COL MVOLT	5,289	42.6	124.1
STAK 2X2 5000LM 80CRI 50K COLT MVOLT	5,164	42.6	121.2
STAK 2X4 3000LM 80CRI 30K COL MVOLT	3,056	24.1	126.9
STAK 2X4 3000LM 80CRI 30K COLT MVOLT	2,976	24.1	123.6
STAK 2X4 3000LM 80CRI 35K COL MVOLT	3,170	24.1	131.6
STAK 2X4 3000LM 80CRI 35K COLT MVOLT	3,086	24.1	128.2

Performance Data			
Luminaire Catalog	Lumens	Wattage	Efficacy
STAK 2X4 3000LM 80CRI 40K COL MVOLT	3,269	24.1	135.8
STAK 2X4 3000LM 80CRI 40K COLT MVOLT	3,183	24.1	132.2
STAK 2X4 3000LM 80CRI 50K COL MVOLT	3,269	24.1	135.8
STAK 2X4 3000LM 80CRI 50K COLT MVOLT	3,183	24.1	132.2
STAK 2X4 4000LM 80CRI 30K COL MVOLT	3,978	33.2	119.8
STAK 2X4 4000LM 80CRI 30K COLT MVOLT	3,873	33.2	116.7
STAK 2X4 4000LM 80CRI 35K COL MVOLT	4,126	33.2	124.3
STAK 2X4 4000LM 80CRI 35K COLT MVOLT	4,017	33.2	121
STAK 2X4 4000LM 80CRI 40K COL MVOLT	4,255	33.2	128.2
STAK 2X4 4000LM 80CRI 40K COLT MVOLT	4,144	33.2	124.8
STAK 2X4 4000LM 80CRI 50K COL MVOLT	4,255	33.2	128.2
STAK 2X4 4000LM 80CRI 50K COLT MVOLT	4,144	33.2	124.8
STAK 2X4 5000LM 80CRI 30K COL MVOLT	5,074	41.9	121
STAK 2X4 5000LM 80CRI 30K COLT MVOLT	4,940	41.9	117.9
STAK 2X4 5000LM 80CRI 35K COL MVOLT	5,262	41.9	125.5
STAK 2X4 5000LM 80CRI 35K COLT MVOLT	5,124	41.9	122.2
STAK 2X4 5000LM 80CRI 40K COL MVOLT	5,428	41.9	129.5
STAK 2X4 5000LM 80CRI 40K COLT MVOLT	5,285	41.9	126.1
STAK 2X4 5000LM 80CRI 50K COL MVOLT	5,428	41.9	129.5
STAK 2X4 5000LM 80CRI 50K COLT MVOLT	5,285	41.9	126.1
STAK 2X4 6000LM 80CRI 30K COL MVOLT	5,819	50.2	115.8
STAK 2X4 6000LM 80CRI 30K COLT MVOLT	5,666	50.2	112.8
STAK 2X4 6000LM 80CRI 35K COL MVOLT	6,035	50.2	120.1
STAK 2X4 6000LM 80CRI 35K COLT MVOLT	5,877	50.2	117
STAK 2X4 6000LM 80CRI 40K COL MVOLT	6,225	50.2	123.9
STAK 2X4 6000LM 80CRI 40K COLT MVOLT	6,061	50.2	120.6
STAK 2X4 6000LM 80CRI 50K COL MVOLT	6,225	50.2	123.9
STAK 2X4 6000LM 80CRI 50K COLT MVOLT	6,061	50.2	120.6
STAK 2X4 7200LM 80CRI 30K COL MVOLT	6,926	55.2	125.6
STAK 2X4 7200LM 80CRI 30K COLT MVOLT	6,744	55.2	122.3
STAK 2X4 7200LM 80CRI 35K COL MVOLT	7,184	55.2	130.3
STAK 2X4 7200LM 80CRI 35K COLT MVOLT	6,995	55.2	126.8
STAK 2X4 7200LM 80CRI 40K COL MVOLT	7,409	55.2	134.3
STAK 2X4 7200LM 80CRI 40K COLT MVOLT	7,215	55.2	130.8
STAK 2X4 7200LM 80CRI 50K COL MVOLT	7,409	55.2	134.3
STAK 2X4 7200LM 80CRI 50K COLT MVOLT	7,215	55.2	130.8



STACK



## FEATURES & SPECIFICATIONS

**INTENDED USE** — Typical applications include corridors, lobbies, conference rooms and private offices.

**CONSTRUCTION** — Galvanized steel mounting/plaster frame; galvanized steel junction box with bottom-hinged access covers and spring latches. Reflectors are retained by torsion springs.

Vertically adjustable mounting brackets with commercial bar hangers provide 3-3/4" total adjustment.

Two combination 1/2"-3/4" and four 1/2" knockouts for straight-through conduit runs. Capacity: 8 (4 in, 4 out). No. 12 AWG conductors, rated for 90°C.

Accommodates 12"-24" joist spacing.

Passive cooling thermal management for 25°C standard; high ambient (40°C) option available. Light engine and drivers are accessible from above or below ceiling.

Max ceiling thickness 1-1/2".

**OPTICS** — LEDs are binned to a 3-step MacAdam Ellipse; 80 CRI minimum. 90 CRI optional. LED light source concealed with diffusing optical lens.

General illumination lighting with 1.0 S/MH and 55° cutoff to source and source image.

Self-flanged anodized reflectors in specular, semi-specular, or matte diffuse finishes. Also available in white and black painted reflectors.

**A+ CAPABLE LUMINAIRE** — This item is an A+ capable luminaire, which has been designed and tested to provide consistent color appearance and out-of-the-box control compatibility with simple commissioning when used with Acuity Brands controls products. All configurations of this luminaire are calibrated and tested to meet the Acuity Brands' specifications for chromatic consistency — including color rendering, color fidelity and color temperature tolerance around standard CIE chromaticity coordinates. To learn more about A+ standards, specifications, and testing visit [www.acuitybrands.com/aplus](http://www.acuitybrands.com/aplus).

**UGR** — UGR is zero for fixtures aimed at nadir with a cut-off equal to or less than 60deg, per CIE 117-1996 Discomfort Glare in Interior Lighting.

**ELECTRICAL** — Multi-volt (120-277V, 50/60Hz) 0-10V dimming drivers mounted to junction box, 10% or 1% minimum dimming level available.

0-10V dimming fixture requires two (2) additional low-voltage wires to be pulled.

**LUMEN MAINTENANCE** — 70% lumen maintenance at 60,000 hours. L70/60,000 hours

**LISTINGS** — Certified to US and Canadian safety standards. Wet location standard (covered ceiling). IP55 rated. ENERGY STAR® certified product. Drivers are RoHS compliant

**BUY AMERICAN ACT** — Product with the BAA option is assembled in the USA and meets the Buy America(n) government procurement requirements under FAR, DFARS and DOT regulations. Please refer to [www.acuitybrands.com/buy-american](http://www.acuitybrands.com/buy-american) for additional information.

**WARRANTY** — 5-year limited warranty. This is the only warranty provided and no other statements in this specification sheet create any warranty of any kind. All other express and implied warranties are disclaimed. Complete warranty terms located at: [www.acuitybrands.com/support/warranty/terms-and-conditions](http://www.acuitybrands.com/support/warranty/terms-and-conditions)

**Note:** Actual performance may differ as a result of end-user environment and application. All values are design or typical values, measured under laboratory conditions at 25 °C. Specifications subject to change without notice.

## PERFORMANCE DATA

LDN6 3500K AR LSS 80CRI			
Nominal Lumens	Lumens	Wattage	Lm/W
500	527.9	5.8	90.5
750	758.1	8.9	85.1
1000	950.1	10.4	91.0
1500	1514	17.5	86.4
2000	2006	22.5	89.1
2500	2504	28.3	88.6
3000	3021	34.8	86.9
4000	4008	44.3	90.6
5000	4975	57.7	86.3

### Notes

- Tested in accordance with IESNA LM-79-08.
- Tested to current IES and NEMA standards under stabilized laboratory conditions.
- CRI: 80 typical.



Catalog Number	
Notes	
Type	L2A

# LDN6 STATIC WHITE

6" Open and Wallwash LED  
Non-IC  
New Construction Downlight

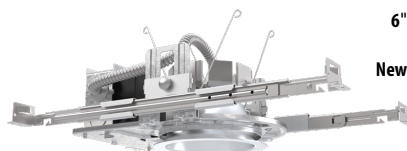

Open Trim



Wallwash Trim

## DISTRIBUTIONS

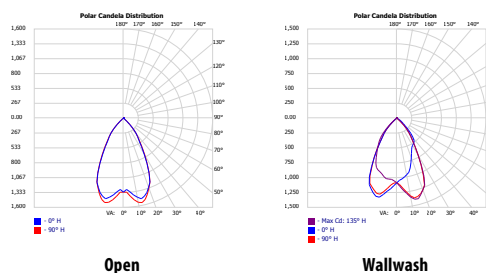

Open

Wallwash

## DIMENSIONS

### LDN6 500-3000 Lumens

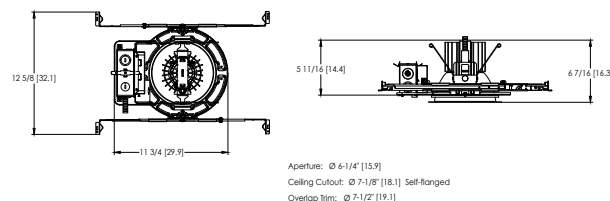

Aperture:  $\varnothing$  6-1/4" [15.9]  
Ceiling Cutout:  $\varnothing$  7-1/8" [18.1] Self-flanged  
Overlap Trim:  $\varnothing$  7-1/2" [19.1]

See page 4 for other fixture dimensions

L2A

LDN6

 Design Select options indicated by this color background.

**ORDERING INFORMATION** Lead times will vary depending on options selected. Consult with your sales representative.

**Example:** LDN6 35/15 L06 AR LSS MVOLT EZ10

LDN6 Series	Color temperature	Lumens ‡	Trim Style	Trim Color	Trim Finish	Flange Color ‡	Voltage
LDN6 6" round	27/ 2700K	05 500 lumens	L06 Downlight	JAR Clear	LSS Semi-specular	TRW White painted flange	MVOLT Multi-volt
	30/ 3000K	07 750 lumens	LW6 Wallwash	WR ‡ White	LD Matte diffuse	TRBL Black painted flange	120 120V
	35/ 3500K	10 1000 lumens		BR ‡ Black	LS Specular	FCPC Custom painted flange only	277 277V
	40/ 4000K	15 1500 lumens		TCPC ‡ Custom painted trim		FRALTBD RAL painted flange only	347 ‡ 347V
	50/ 5000K	20 2000 lumens		TRALTBD ‡ RAL painted trim			
		25 2500 lumens					
		30 3000 lumens					
		40 4000 lumens					
		50 5000 lumens					

Driver	Emergency ‡	Control Input ‡	Options
GZ10 0-10V driver dims to 10%	(blank) No Emergency Needed	(blank) No Control Input Needed	HAO ‡ High ambient option (40°C)
GZ1 0-10V driver dims to 1%	EL Battery pack (10W constant power), non-T20 compliant, integral test switch	JOT Wireless room control with "Just One Touch" pairing	CP ‡ Chicago Plenum
D10 Minimum dimming 10% driver for use with JOT	ELR Battery pack (10W constant power), non-T20 compliant, remote test switch	NPP16D nLight™ network power/relay pack with 0-10V dimming for non-eldoLED drivers (GZ10, GZ1).	RRL RELOC®-ready luminaire connectors enable a simple and consistent factory installed option across all ABL luminaire brands. Refer to RRL for complete nomenclature. Available only in RRLA, RRLB, RRLAE, and RRLC125.
D1 Minimum dimming 1% driver for use with JOT	ELSD Self-diagnostic battery pack (10W constant power), non-T20 compliant, integral test switch	NPP16DER nLight™ network power/relay pack with 0-10V dimming for non-eldoLED drivers (GZ10, GZ1). ER controls fixtures on emergency circuit.	BAA Buy America(n) Act Compliant
EZ1 0-10V eldoLED driver with smooth and flicker-free deep dimming performance down to 1%	ELRSD Self-diagnostic battery pack (10W constant power), non-T20 compliant, remote test switch	NPS80EZ nLight™ dimming pack controls 0-10V eldoLED drivers (EZ1).	90CRI High CRI (90+)
EDAB eldoLED DALI SOLD/DRIVE dim to dark	E10WCP Battery pack (10W constant power), T20 compliant, integral test switch	NPS80EZER nLight™ dimming pack controls 0-10V eldoLED drivers (EZ1). ER controls fixtures on emergency circuit.	SF ‡ Single fuse
	E10WCPR Battery pack (10W constant power), T20 compliant, remote test switch	N80 nLight™ Lumen Compensation	
	E10WRSTAR Emergency battery pack, 10W with remote test switch and Iota STAR technology	NLTAIR2 nLight™ Air enabled	
		NLTAIRER2 nLight™ AIR Dimming Pack Wireless Controls. Controls fixtures on emergency circuit, not available with battery pack options	
		NLTAIREM2 nLight™ AIR Dimming Pack Wireless Controls. UL924 Emergency Operation, via power interrupt detection. Available with battery pack options.	

‡ Option Value Ordering Restrictions	
Option value	Restriction
Lumens	Overall height varies based on lumen package; refer to dimensional chart.
WR, BR	Not available with finishes.
347	Not available with emergency options.
SF	Must specify voltage 120V or 277V.
TRW, TRBL	Available with clear (AR) reflector only.
EL, ELR, ELSD, ELRSD, E10WCP, E10WCPR	12.5" of plenum depth or top access required for battery pack maintenance.
NPP16D, NPP16DER, NPS80EZ, NPS80EZER	Specify voltage. ER for use with generator supply EM power. Will require an emergency hot feed and normal hot feed. See UL 924 Sequence of Operation table.
N80	Fixture begins at 80% light level. Must be specified with NPS80EZ or NPS80EZ ER. Only available with EZ1 drivers.
NLTAIR, NLTAIR2, NLTAIRER2, NLTAIREM2	Not available with CP, NPS80EZ, NPS80EZER, NPP16D, NPP16DER or N80 options. not recommended for metal ceiling installations.
HAO	Fixture height is 6.5" for all lumen packages with HAO.
CP	Must specify voltage for 3000lm and above. 5000lm with marked spacing 24 L x 24 W x 14 H. Not available with emergency battery pack option.
JOT	Must specify D10 or D1 driver. Not available with nLight options. Not available with CP. Not recommended for metal ceiling installation. Not for use with emergency backup power systems other than battery packs.
Reloc® Options	Refer to RRL specification sheet on acuitybrands.com for further details.
RRLAE	Commercial fixtures should disconnect the TSPL before unplugging the RRL so it does not go into discharge mode.
RRLC125	RRLC125 option is to be used with the OnePass OCU, OCS, OD, OFC and OD for 0-24V integrated single-circuit or 0-10V low voltage controls applications. Not available with integral dimming sensors.
TRALTBD, FRALTBD	RALTBD for pricing only. Replace with applicable RAL number and finish when ready to order. See the RAL BROCHURE for available color options.
TCPC, FCPC	CPC options for pricing only. Custom color chip needs to be sent in to your Customer Resolution specialist before order can be processed. Click HERE for more details
E10WRSTAR	Not available with wet location, ECT, EC6, QDS, CP, 347V, NPS80EZ ER, NLTAIRER2, NLTAIREM2, AL03 & AL04 w/DALI, OR 2000-4500 lumens w/JOT. Top access installation or 17.5" plenum clearance required for roomside installation. Not available with integral test switch

Accessories: Order as separate catalog number.		
EAC ISSM 375	Compact interruptible emergency AC power system	SCA6 Sloped Ceiling Adapter. Degree of slope must be specified (5D, 10D, 15D, 20D, 25D, 30D). Ex: SCA6 10D
EAC ISSM 125	Compact interruptible emergency AC power system	
GRA68 JZ	Oversized trim ring with 8" outside diameter	

 design select

Items marked by a shaded background qualify for the Design Select program and ship in 15 days or less. To learn more about Design Select, visit [www.acuitybrands.com/designselect](http://www.acuitybrands.com/designselect). \*See ordering tree for details

(Maximum order quantity for design select lead times is 112.)



LDN6

L2A

**LDN6**

**Emergency Battery Pack Options - Field Installable**

Battery Model Number	Wattage	Runtime (Minutes)	Lumen Output* @ 120 Lumens/Watt	Other
<a href="#">ILB CP07 2H A</a>	7W	120	840	Storm Shelter / 2 Hour Runtime
<a href="#">ILB CP10 A</a>	10W	90	1200	
<a href="#">ILBLP CP10 HE SD A+</a>	10W	90	1200	Title 20, Self Diagnostic
<a href="#">ILBLP CP15 HE SD A+</a>	15W	90	1800	Title 20, Self Diagnostic
<a href="#">ILB CP20 HE A</a>	20W	90	2400	Title 20
<a href="#">ILB CP20 HE SD A</a>	20W	90	2400	Title 20, Self Diagnostic
<a href="#">ILBHI CP10 HE SD A+</a>	10W	90	1200	347-480V AC Input, Title 20, Self Diagnostic
<a href="#">ILBHI CP15 HE SD A+</a>	15W	90	1800	347-480V AC Input, Title 20, Self Diagnostic

All the above are UL Listed products that are certified for field install external/remote to the fixture.  
 \*Minimum delivered lumen output to assist in product selection for increased fixture mounting height.  
 The CP10 delivered emergency illumination outperforms legacy 1400 lumen fluorescent emergency ballast.  
 Please contact us at [techsupport@iotaengineering.com](mailto:techsupport@iotaengineering.com) for any Emergency Battery related questions.



LDN6

L2A

LDN6

PHOTOMETRY

Distribution Curve      Distribution Data      Output Data      Illuminance Data at 30° Above Floor for a Single Luminaire

LDN6 35/10 L06AR, input watts: 10.44, delivered lumens: 987.10, LM/W = 94.54, spacing criterion at 0= 1.02, test no. ISF 30716P265.

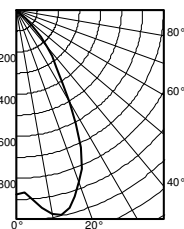

Ave Lumens	Zone	Lumens	% Lamp
0	0° - 30°	680.7	69.0
5	0° - 40°	895.0	90.7
15	0° - 60°	986.0	99.9
25	720	322	
35	330	214	
45	110	87	
55	1	4	
65	1	1	
75	0	0	
85	0	0	
90	0	0	

Initial FC		50% beam - 54.5°		10% beam - 82.2°	
Mounting Height	Center Beam Diameter	FC Diameter	FC	Diameter	FC
8.0	29.0	5.7	14.5	9.6	2.9
10.0	15.6	7.7	7.8	13.1	1.6
12.0	9.7	9.8	4.9	16.6	1.0
14.0	6.6	11.8	3.3	20.1	0.7
16.0	4.8	13.9	2.4	23.6	0.5

LDN6 35/15 L06AR, input watts: 17.52, delivered lumens: 1572.9, LM/W = 89.77, spacing criterion at 0= 1.02, test no. ISF 30716P265.

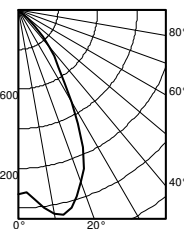

Ave Lumens	Zone	Lumens	% Lamp
0	0° - 30°	1084.6	69.0
5	0° - 40°	1426.2	90.7
15	0° - 60°	1571.3	99.9
25	1147	514	
35	526	342	
45	176	139	
55	2	6	
65	1	1	
75	1	1	
85	0	0	
90	0	0	

Initial FC		50% beam - 54.5°		10% beam - 82.2°	
Mounting Height	Center Beam Diameter	FC Diameter	FC	Diameter	FC
8.0	46.2	5.7	23.1	9.6	4.6
10.0	24.8	7.7	12.4	13.1	2.5
12.0	15.5	9.8	7.7	16.6	1.5
14.0	10.6	11.8	5.3	20.1	1.1
16.0	7.7	13.9	3.8	23.6	0.8

LDN6 35/30 L06AR, input watts: 34.75, delivered lumens: 3138.5, LM/W = 90.31, spacing criterion at 0= 1.02, test no. ISF 30716P274.

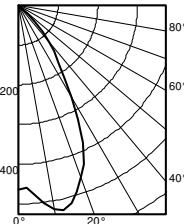

Ave Lumens	Zone	Lumens	% Lamp
0	0° - 30°	2164.3	69.0
5	0° - 40°	2845.9	90.7
15	0° - 60°	3135.3	99.9
25	2289	1025	
35	1049	682	
45	350	277	
55	5	12	
65	2	2	
75	1	1	
85	0	0	
90	0	0	

Initial FC		50% beam - 54.5°		10% beam - 82.2°	
Mounting Height	Center Beam Diameter	FC Diameter	FC	Diameter	FC
8.0	92.1	5.7	46.1	9.6	9.2
10.0	49.5	7.7	24.4	13.1	5.0
12.0	30.9	9.8	15.4	16.6	3.1
14.0	21.1	11.8	10.5	20.1	2.1
16.0	15.3	13.9	7.6	23.6	1.5

HOW TO ESTIMATE DELIVERED LUMENS IN EMERGENCY MODE

Use the formula below to estimate the delivered lumens in emergency mode

**Delivered Lumens = 1.25 x P x LPW**

P = Output power of emergency driver. P = 10W for PS1055CP

LPW = Lumen per watt rating of the luminaire. This information is available on the ABL luminaire spec sheet.

The LPW rating is also available at [Designlight Consortium](http://Designlight Consortium).

Notes

- Tested in accordance with IESNA LM-79-08.
- Tested to current IES and NEMA standards under stabilized laboratory conditions.
- CRI: 80 typical.

LUMEN OUTPUT MULTIPLIERS - FINISH			
	Clear (AR)	White (WR)	Black (BR)
Specular (LS)	1.0	N/A	N/A
Semi-specular (LSS)	0.950	N/A	N/A
Matte diffuse (LD)	0.85	N/A	N/A
Painted	N/A	0.87	0.73

LUMEN OUTPUT MULTIPLIERS - CRI	
80	1.0
90	0.874

LUMEN OUTPUT MULTIPLIERS - CCT					
	2700K	3000K	3500K	4000K	5000K
80CRI	0.950	0.966	1.000	1.025	1.101



LDN6

L2A

**LDN6**

\* All dimensions are inches (centimeters) unless otherwise noted.

**LDN6 500-3000 Lumens**

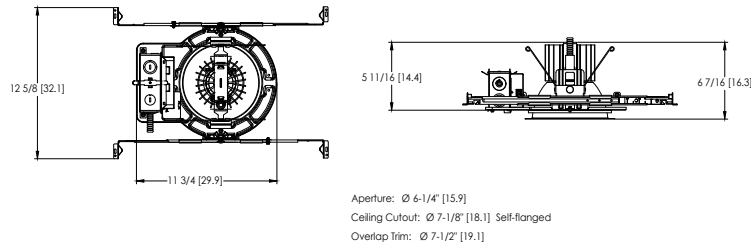

**LDN6 4000-5000 Lumens**

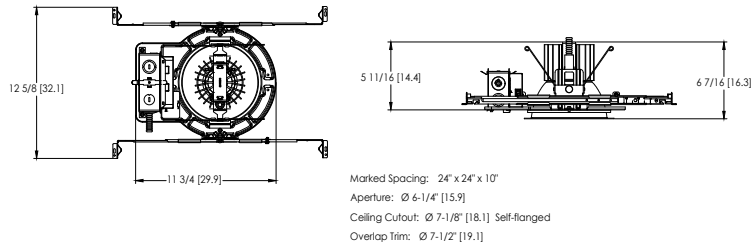

**LDN6 CP**

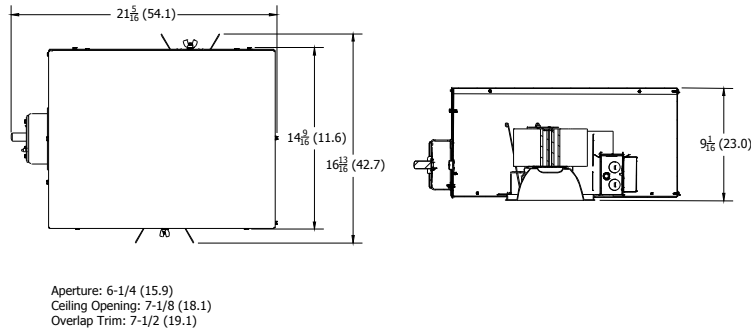

**LDN6 EL**

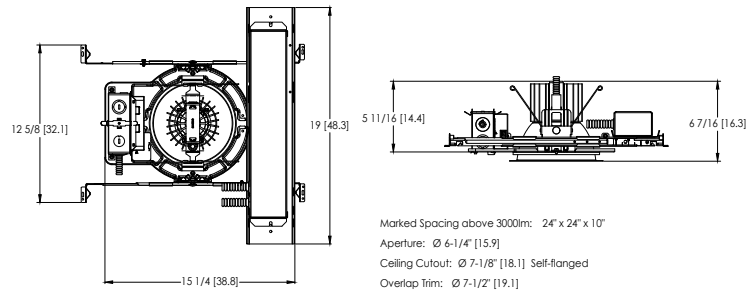

LDN6

L2A

LDN6

ADDITIONAL DATA



The Sensor Switch JOT enabled solution offers a wireless, app-free approach to single room lighting control. JOT enabled products use Bluetooth® Low Energy (BLE) technology to enable wireless dimming and switching.

Diagram



LDN6 Series



Sensor Switch  
WSXA JOT

1. **Power:** Install JOT enabled fixtures and controls as instructed.
2. **Pair:** Insert the pairing tool into the pinhole on the wall switch; press and hold any button for 6 seconds.
3. **Play:** Once paired, each fixture will individually dim down to 10% brightness. All products will be fully functional.

COMPATIBLE 0-10V WALL-MOUNT DIMMERS		
MANUFACTURER	PART NO.	POWER BOOSTER AVAILABLE
Lutron®	Diva® DDTV	
	Diva® DVSCTV	
	Nova™ NTFTV	
	Nova® NFTV	
Leviton®	AWSMT-7DW	CN100
	AWSMG-7DW	PE300
	AMRMG-7DW	
	Leviton Centura Fluorescent Control System	
	IllumaTech® IP7 Series	
Synergy®	ISD BC	RDMFC
	SLD LPCS	
	Digital Equinox (DEQ BC)	
Douglas Lighting Controls	WPC-5721	
Entertainment Technology	Tap Glide TG600FAM120 (120V)	
	Tap Glide Heatsink TGH1500FAM120 (120V)	
	Oasis OA2000FAMU	
Honeywell	EL7315A1019	EL7305A1010 (optional)
	EL7315A1009	
HUNT Dimming	Preset slide: PS-010-IV and PS-010-WH	
	Preset slide: PS-010-3W-IV and PS-010-3W-WH	
	Preset slide, controls FD-010: PS-IFC-010-IV and PS-IFC-010-WH-120/277V	
	Preset slide, controls FD-010: PS-IFC-010-3W-IV and PS-IFC-010-3W-WH-120/277V	
	Remote mounted unit: FD-010	
Lehigh Electronic Products	Solitaire	PBX
PDM Electrical Products	WPC-5721	
Starfield Controls	TR61 with DALI interface port	RT03 DALI.net Router
WattStopper®	LS-4 used with LCD-101 and LCD-103	



LDN6

L2A

**LDN6**

**EXAMPLE**

Group Fixture Control\*

\*Application diagram applies for fixtures with eldoLED drivers only.

- nPS 80 EZ** Dimming/Control Pack (qty: 2 required)
- nPODM 2P DX** Dual On/Off/Dim Push-Button WallPod
- nCM ADCX** Daylight Sensor with Automatic Dimming Control
- nCM PDT 9** Dual Technology Occupancy Sensor

**Description:** This design provides a dual on/off/dim wall station that enables manual control of the fixtures in Row A and Row B separately. Additionally, a daylight harvesting sensor is provided so the lights in Row B can be configured to dim automatically when daylight is available. An occupancy sensor turns off all lights when the space is vacant.

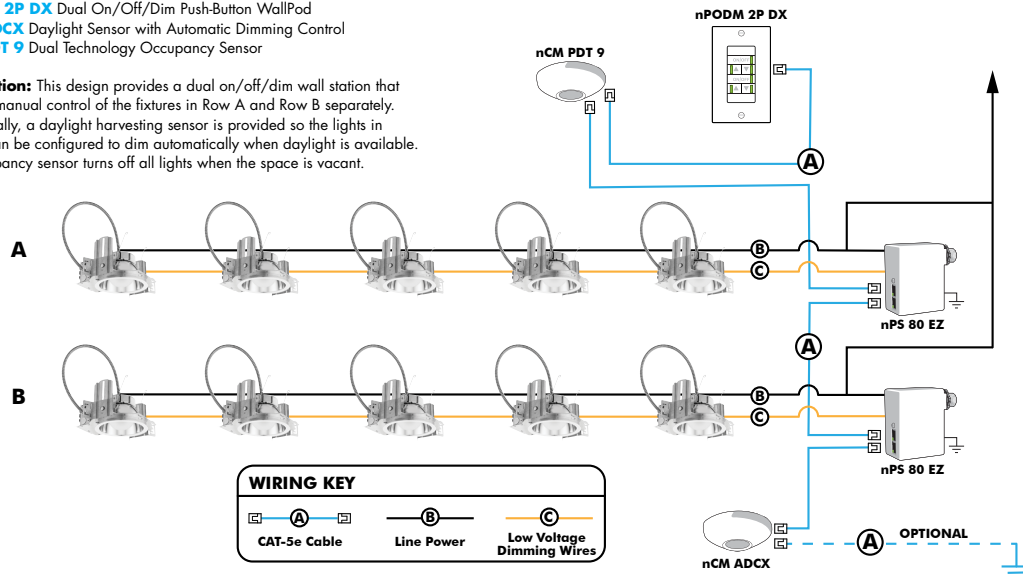

**Choose Wall Controls**

nLight offers multiple styles of wall controls - each with varying features and user experience.



**Push-Button Wallpod**  
Traditional tactile buttons and LED user feedback



**Graphic Wallpod**  
Full color touch screen provides a sophisticated look and feel

**nLight® Wired Controls Accessories:**

Order as separate catalog number. Visit <a href="http://www.acuitybrands.com/products/controls/nlight">www.acuitybrands.com/products/controls/nlight</a> for complete listing of nLight controls.			
WallPod Stations	Model number	Occupancy sensors	Model Number
On/Off	nPODM (Color)	Small motion 360°, ceiling (PIR/dual Tech)	nCM 9 / nCM PDT 9
On/Off & Raise/Lower	nPOD DX (Color)	Large motion 360°, ceiling (PIR/dual tech)	nCM 10 / nCM PDT 10
Graphic Touchscreen	nPOD GFX (Color)	Wide View (PIR/dual tech)	nWV 16 / nWV PDT 16
<b>Photocell controls</b>	<b>Model Number</b>	Wall Switch w/ Raise/Lower (PIR/dual tech)	nWSX LV DX / nWSX PDT LV DX
Dimming	nCM ADCX	<b>Cat-5 cables (plenum rated)</b>	<b>Model Number</b>
		10', CAT5 10FT	CAT5 10FT J1
		15', CAT5 15FT	CAT5 15FT J1



LDN6



L2A

**LDN6**

<b>nLight® AIR Control Accessories:</b>	
<i>Order as separate catalog number. Visit <a href="http://www.acuitybrands.com/products/controls/nlightair">www.acuitybrands.com/products/controls/nlightair</a>.</i>	
Wall switches	Model number
On/Off single pole	rPODB [color]
On/Off two pole	rPODB 2P [color]
On/Off & raise/lower single pole	rPODB DX [color]
On/Off & raise/lower two pole	rPODB 2P DX [color]
On/Off & raise/lower single pole	rPODBZ DX WH <sup>1</sup>

**UL924 Sequence of Operation**

The below information applies to all nLight AIR devices with an EM option.

- EM devices will remain at their high-end trim and ignore wireless lighting control commands, unless a normal-power-sensed (NPS) broadcast is received at least every 8 seconds.
- Using the CLAIRITY+ mobile app, EM devices must be associated with a group that includes a normal power sensing device to receive NPS broadcasts.
- Only non-emergency rPP20, rLSXR, rSBOR, rSDGR, and nLight AIR luminaires with version 3.4 or later firmware can provide normal power sensing for EM devices. See specification sheets for control devices and luminaires for more information on options that support normal power sensing.

- Notes**
- Can only be ordered with the RES7Z zone control sensor version.

**nLight AIR**

nLight AIR is the ideal solution for retrofit or new construction spaces where adding communication is cost prohibitive. The integrated nLight AIR rPP20 Power Pack is part of each Lithonia LDN Luminaire. These individually addressable controls offer the ultimate in flexibility during initial setup and for space repurposing.

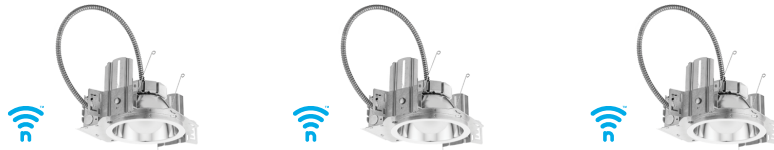

**Simple as 1,2,3**

1. Install the nLight® AIR fixtures with embedded smart sensor
2. Install the wireless battery-powered wall switch
3. With CLAIRITY app, pair the fixtures with the wall switch and if desired, customize the sensor settings for the desired outcome



LDN6



## FEATURES & SPECIFICATIONS

**INTENDED USE** — Typical applications include corridors, lobbies, conference rooms and private offices.

**CONSTRUCTION** — Galvanized steel mounting/plaster frame; galvanized steel junction box with bottom-hinged access covers and spring latches. Reflectors are retained by torsion springs.

Vertically adjustable mounting brackets with commercial bar hangers provide 3-3/4" total adjustment.

Two combination 1/2"-3/4" and four 1/2" knockouts for straight-through conduit runs. Capacity: 8 (4 in, 4 out). No. 12 AWG conductors, rated for 90°C.

Accommodates 12"-24" joist spacing.

Passive cooling thermal management for 25°C standard; high ambient (40°C) option available. Light engine and drivers are accessible from above or below ceiling.

Max ceiling thickness 1-1/2".

**OPTICS** — LEDs are binned to a 3-step MacAdam Ellipse; 80 CRI minimum. 90 CRI optional. LED light source concealed with diffusing optical lens.

General illumination lighting with 1.0 S/MH and 55° cutoff to source and source image.

Self-flanged anodized reflectors in specular, semi-specular, or matte diffuse finishes. Also available in white and black painted reflectors.

**A+ CAPABLE LUMINAIRE** — This item is an A+ capable luminaire, which has been designed and tested to provide consistent color appearance and out-of-the-box control compatibility with simple commissioning when used with Acuity Brands controls products. All configurations of this luminaire are calibrated and tested to meet the Acuity Brands' specifications for chromatic consistency — including color rendering, color fidelity and color temperature tolerance around standard CIE chromaticity coordinates. To learn more about A+ standards, specifications, and testing visit [www.acuitybrands.com/aplus](http://www.acuitybrands.com/aplus).

**UGR** — UGR is zero for fixtures aimed at nadir with a cut-off equal to or less than 60deg, per CIE 117-1996 Discomfort Glare in Interior Lighting.

**ELECTRICAL** — Multi-volt (120-277V, 50/60Hz) 0-10V dimming drivers mounted to junction box, 10% or 1% minimum dimming level available.

0-10V dimming fixture requires two (2) additional low-voltage wires to be pulled.

**LUMEN MAINTENANCE** — 70% lumen maintenance at 60,000 hours. L70/60,000 hours

**LISTINGS** — Certified to US and Canadian safety standards. Wet location standard (covered ceiling). IP55 rated. ENERGY STAR® certified product. Drivers are RoHS compliant

**BUY AMERICAN ACT** — Product with the BAA option is assembled in the USA and meets the Buy America(n) government procurement requirements under FAR, DFARS and DOT regulations. Please refer to [www.acuitybrands.com/buy-american](http://www.acuitybrands.com/buy-american) for additional information.

**WARRANTY** — 5-year limited warranty. This is the only warranty provided and no other statements in this specification sheet create any warranty of any kind. All other express and implied warranties are disclaimed. Complete warranty terms located at: [www.acuitybrands.com/support/warranty/terms-and-conditions](http://www.acuitybrands.com/support/warranty/terms-and-conditions)

**Note:** Actual performance may differ as a result of end-user environment and application. All values are design or typical values, measured under laboratory conditions at 25 °C. Specifications subject to change without notice.

## PERFORMANCE DATA

LDN6 3500K AR LSS 80CRI			
Nominal Lumens	Lumens	Wattage	Lm/W
500	527.9	5.8	90.5
750	758.1	8.9	85.1
1000	950.1	10.4	91.0
1500	1514	17.5	86.4
2000	2006	22.5	89.1
2500	2504	28.3	88.6
3000	3021	34.8	86.9
4000	4008	44.3	90.6
5000	4975	57.7	86.3

### Notes

- Tested in accordance with IESNA LM-79-08.
- Tested to current IES and NEMA standards under stabilized laboratory conditions.
- CRI: 80 typical.



Catalog Number	
Notes	
Type	L2B

# LDN6 STATIC WHITE

6" Open and Wallwash LED  
Non-IC  
New Construction Downlight

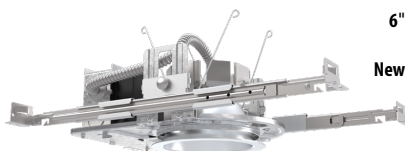

Open Trim



Wallwash Trim

## DISTRIBUTIONS

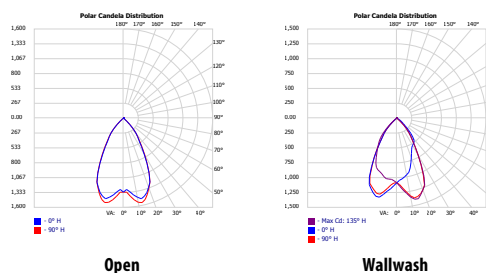

Open

Wallwash

## DIMENSIONS

### LDN6 500-3000 Lumens

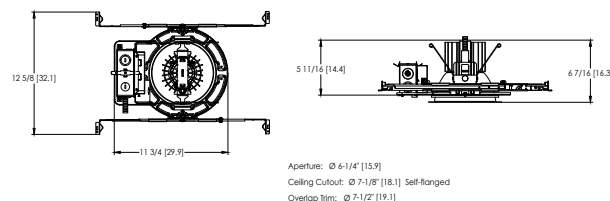

See page 4 for other fixture dimensions

L2B

LDN6

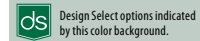

**ORDERING INFORMATION** Lead times will vary depending on options selected. Consult with your sales representative.

**Example:** LDN6 35/15 L06 AR LSS MVOLT EZ10

LDN6 Series	Color temperature	Lumens ‡	Trim Style	Trim Color	Trim Finish	Flange Color ‡	Voltage
LDN6 6" round	27/ 2700K	05 500 lumens	L06 Downlight	AR Clear	LSS Semi-specular	TRW White painted flange	MVOLT Multi-volt
	30/ 3000K	07 750 lumens	LW6 Wallwash	WR ‡ White	LD Matte diffuse	TRBL Black painted flange	120 120V
	35/ 3500K	10 1000 lumens		BR ‡ Black	LS Specular	FCPC Custom painted flange only	277 277V
	40/ 4000K	15 1500 lumens		TCPC ‡ Custom painted trim		FRALTBD RAL painted flange only	347 ‡ 347V
	50/ 5000K	20 2000 lumens		TRALTBD ‡ RAL painted trim			
		25 2500 lumens					
		30 3000 lumens					
		40 4000 lumens					
		50 5000 lumens					

Driver	Emergency ‡	Control Input ‡	Options
GZ10 0-10V driver dims to 10%	(blank) No Emergency Needed	(blank) No Control Input Needed	HAO ‡ High ambient option (40°C)
GZ1 0-10V driver dims to 1%	EL Battery pack (10W constant power), non-T20 compliant, integral test switch	JOT Wireless room control with "Just One Touch" pairing	CP ‡ Chicago Plenum
D10 Minimum dimming 10% driver for use with JOT	ELR Battery pack (10W constant power), non-T20 compliant, remote test switch	NPP16D nLight™ network power/relay pack with 0-10V dimming for non-eldoLED drivers (GZ10, GZ1).	RRL RELOC®-ready luminaire connectors enable a simple and consistent factory installed option across all ABL luminaire brands. Refer to RRL for complete nomenclature. Available only in RRLA, RRLB, RRLAE, and RRLC125.
D1 Minimum dimming 1% driver for use with JOT	ELSD Self-diagnostic battery pack (10W constant power), non-T20 compliant, integral test switch	NPP16DER nLight™ network power/relay pack with 0-10V dimming for non-eldoLED drivers (GZ10, GZ1). ER controls fixtures on emergency circuit.	BAA Buy America(n) Act Compliant
EZ1 0-10V eldoLED driver with smooth and flicker-free deep dimming performance down to 1%	ELRSD Self-diagnostic battery pack (10W constant power), non-T20 compliant, remote test switch	NPS80EZ nLight™ dimming pack controls 0-10V eldoLED drivers (EZ1).	90CRI High CRI (90+)
EDAB eldoLED DALI SOLD/DRIVE dim to dark	E10WCP Battery pack (10W constant power), T20 compliant, integral test switch	NPS80EZER nLight™ dimming pack controls 0-10V eldoLED drivers (EZ1). ER controls fixtures on emergency circuit.	SF ‡ Single fuse
	E10WCPR Battery pack (10W constant power), T20 compliant, remote test switch	N80 nLight™ Lumen Compensation	
	E10WRSTAR Emergency battery pack, 10W with remote test switch and Iota STAR technology	NLTAIR2 nLight™ Air enabled	
		NLTAIRER2 nLight™ AIR Dimming Pack Wireless Controls. Controls fixtures on emergency circuit, not available with battery pack options	
		NLTAIREM2 nLight™ AIR Dimming Pack Wireless Controls. UL924 Emergency Operation, via power interrupt detection. Available with battery pack options.	

‡ Option Value Ordering Restrictions	
Option value	Restriction
Lumens	Overall height varies based on lumen package; refer to dimensional chart.
WR, BR	Not available with finishes.
347	Not available with emergency options.
SF	Must specify voltage 120V or 277V.
TRW, TRBL	Available with clear (AR) reflector only.
EL, ELR, ELSD, ELRSD, E10WCP, E10WCPR	12.5" of plenum depth or top access required for battery pack maintenance.
NPP16D, NPP16DER, NPS80EZ, NPS80EZER	Specify voltage. ER for use with generator supply EM power. Will require an emergency hot feed and normal hot feed. See UL 924 Sequence of Operation table.
N80	Fixture begins at 80% light level. Must be specified with NPS80EZ or NPS80EZ ER. Only available with EZ1 drivers.
NLTAIR, NLTAIR2, NLTAIRER2, NLTAIREM2	Not available with CP, NPS80EZ, NPS80EZER, NPP16D, NPP16DER or N80 options. not recommended for metal ceiling installations.
HAO	Fixture height is 6.5" for all lumen packages with HAO.
CP	Must specify voltage for 3000lm and above. 5000lm with marked spacing 24 L x 24 W x 14 H. Not available with emergency battery pack option.
JOT	Must specify D10 or D1 driver. Not available with nLight options. Not available with CP. Not recommended for metal ceiling installation. Not for use with emergency backup power systems other than battery packs.
Reloc® Options	Refer to RRL specification sheet on acuitybrands.com for further details.
RRLAE	Commercial fixtures should disconnect the TSPL before unplugging the RRL so it does not go into discharge mode.
RRLC125	RRLC125 option is to be used with the OnePass OCU, OCS, OD, OFC and OD for 0-24V integrated single-circuit or 0-10V low voltage controls applications. Not available with integral dimming sensors.
TRALTBD, FRALTBD	RALTBD for pricing only. Replace with applicable RAL number and finish when ready to order. See the RAL BROCHURE for available color options.
TCPC, FCPC	CPC options for pricing only. Custom color chip needs to be sent in to your Customer Resolution specialist before order can be processed. Click HERE for more details
E10WRSTAR	Not available with wet location, ECT, EC6, QDS, CP, 347V, NPS80EZ ER, NLTAIRER2, NLTAIREM2, AL03 & AL04 w/DALI, OR 2000-4500 lumens w/JOT. Top access installation or 17.5" plenum clearance required for roomside installation. Not available with integral test switch

Accessories: Order as separate catalog number.		
EAC ISSM 375	Compact interruptible emergency AC power system	SCA6 Sloped Ceiling Adapter. Degree of slope must be specified (5D, 10D, 15D, 20D, 25D, 30D). Ex: SCA6 10D
EAC ISSM 125	Compact interruptible emergency AC power system	
GRA68 JZ	Oversized trim ring with 8" outside diameter	

**ds design select**

Items marked by a shaded background qualify for the Design Select program and ship in 15 days or less. To learn more about Design Select, visit [www.acuitybrands.com/designselect](http://www.acuitybrands.com/designselect). \*See ordering tree for details

(Maximum order quantity for design select lead times is 112.)



LDN6

L2B

**LDN6**

**Emergency Battery Pack Options - Field Installable**

Battery Model Number	Wattage	Runtime (Minutes)	Lumen Output* @ 120 Lumens/Watt	Other
<a href="#">ILB CP07 2H A</a>	7W	120	840	Storm Shelter / 2 Hour Runtime
<a href="#">ILB CP10 A</a>	10W	90	1200	
<a href="#">ILBLP CP10 HE SD A+</a>	10W	90	1200	Title 20, Self Diagnostic
<a href="#">ILBLP CP15 HE SD A+</a>	15W	90	1800	Title 20, Self Diagnostic
<a href="#">ILB CP20 HE A</a>	20W	90	2400	Title 20
<a href="#">ILB CP20 HE SD A</a>	20W	90	2400	Title 20, Self Diagnostic
<a href="#">ILBHI CP10 HE SD A+</a>	10W	90	1200	347-480V AC Input, Title 20, Self Diagnostic
<a href="#">ILBHI CP15 HE SD A+</a>	15W	90	1800	347-480V AC Input, Title 20, Self Diagnostic

All the above are UL Listed products that are certified for field install external/remote to the fixture.  
 \*Minimum delivered lumen output to assist in product selection for increased fixture mounting height.  
 The CP10 delivered emergency illumination outperforms legacy 1400 lumen fluorescent emergency ballast.  
 Please contact us at [techsupport@iotaengineering.com](mailto:techsupport@iotaengineering.com) for any Emergency Battery related questions.



LDN6

L2B

LDN6

PHOTOMETRY

Distribution Curve      Distribution Data      Output Data      Illuminance Data at 30° Above Floor for a Single Luminaire

LDN6 35/10 L06AR, input watts: 10.44, delivered lumens: 987.10, LM/W = 94.54, spacing criterion at 0= 1.02, test no. ISF 30716P265.

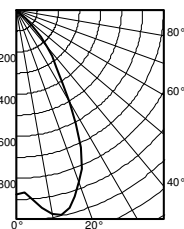

Ave Lumens	Zone	Lumens	% Lamp
0	0° - 30°	680.7	69.0
5	0° - 40°	895.0	90.7
15	0° - 60°	986.0	99.9
25	720	322	
35	330	214	
45	110	87	
55	1	4	
65	1	1	
75	0	0	
85	0	0	
90	0	0	

Initial FC		50% beam - 54.5°		10% beam - 82.2°	
Mounting Height	Center Beam Diameter	FC Diameter	FC	Diameter	FC
8.0	29.0	5.7	14.5	9.6	2.9
10.0	15.6	7.7	7.8	13.1	1.6
12.0	9.7	9.8	4.9	16.6	1.0
14.0	6.6	11.8	3.3	20.1	0.7
16.0	4.8	13.9	2.4	23.6	0.5

LDN6 35/15 L06AR, input watts: 17.52, delivered lumens: 1572.9, LM/W = 89.77, spacing criterion at 0= 1.02, test no. ISF 30716P265.

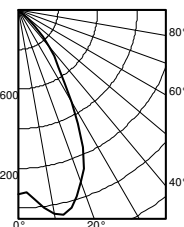

Ave Lumens	Zone	Lumens	% Lamp
0	0° - 30°	1084.6	69.0
5	0° - 40°	1426.2	90.7
15	0° - 60°	1571.3	99.9
25	1147	514	
35	526	342	
45	176	139	
55	2	6	
65	1	1	
75	1	1	
85	0	0	
90	0	0	

Initial FC		50% beam - 54.5°		10% beam - 82.2°	
Mounting Height	Center Beam Diameter	FC Diameter	FC	Diameter	FC
8.0	46.2	5.7	23.1	9.6	4.6
10.0	24.8	7.7	12.4	13.1	2.5
12.0	15.5	9.8	7.7	16.6	1.5
14.0	10.6	11.8	5.3	20.1	1.1
16.0	7.7	13.9	3.8	23.6	0.8

LDN6 35/30 L06AR, input watts: 34.75, delivered lumens: 3138.5, LM/W = 90.31, spacing criterion at 0= 1.02, test no. ISF 30716P274.

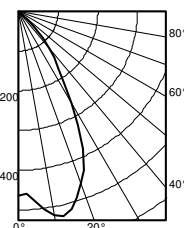

Ave Lumens	Zone	Lumens	% Lamp
0	0° - 30°	2164.3	69.0
5	0° - 40°	2845.9	90.7
15	0° - 60°	3135.3	99.9
25	2289	1025	
35	1049	692	
45	350	277	
55	5	12	
65	2	2	
75	1	1	
85	0	0	
90	0	0	

Initial FC		50% beam - 54.5°		10% beam - 82.2°	
Mounting Height	Center Beam Diameter	FC Diameter	FC	Diameter	FC
8.0	92.1	5.7	46.1	9.6	9.2
10.0	49.5	7.7	24.4	13.1	5.0
12.0	30.9	9.8	15.4	16.6	3.1
14.0	21.1	11.8	10.5	20.1	2.1
16.0	15.3	13.9	7.6	23.6	1.5

HOW TO ESTIMATE DELIVERED LUMENS IN EMERGENCY MODE

Use the formula below to estimate the delivered lumens in emergency mode

**Delivered Lumens = 1.25 x P x LPW**

P = Output power of emergency driver. P = 10W for PS1055CP

LPW = Lumen per watt rating of the luminaire. This information is available on the ABL luminaire spec sheet.

The LPW rating is also available at [Designlight Consortium](http://Designlight Consortium).

Notes

- Tested in accordance with IESNA LM-79-08.
- Tested to current IES and NEMA standards under stabilized laboratory conditions.
- CRI: 80 typical.

LUMEN OUTPUT MULTIPLIERS - FINISH			
	Clear (AR)	White (WR)	Black (BR)
Specular (LS)	1.0	N/A	N/A
Semi-specular (LSS)	0.950	N/A	N/A
Matte diffuse (LD)	0.85	N/A	N/A
Painted	N/A	0.87	0.73

LUMEN OUTPUT MULTIPLIERS - CRI	
80	1.0
90	0.874

LUMEN OUTPUT MULTIPLIERS - CCT					
	2700K	3000K	3500K	4000K	5000K
80CRI	0.950	0.966	1.000	1.025	1.101



LDN6

L2B

**LDN6**

\* All dimensions are inches (centimeters) unless otherwise noted.

**LDN6 500-3000 Lumens**

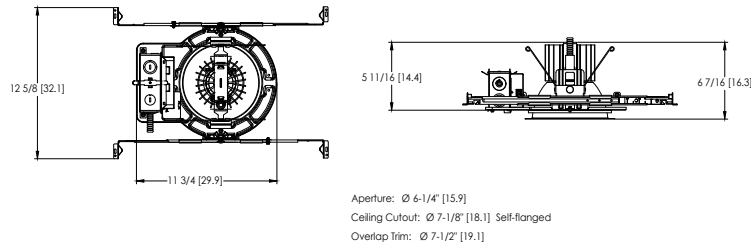

**LDN6 4000-5000 Lumens**

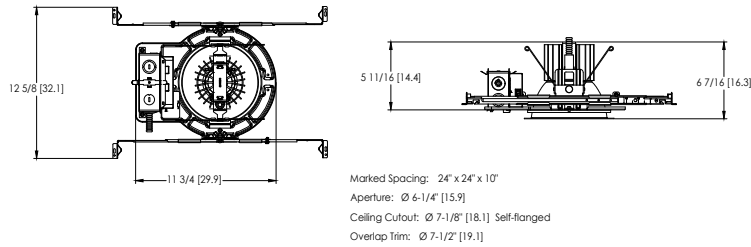

**LDN6 CP**

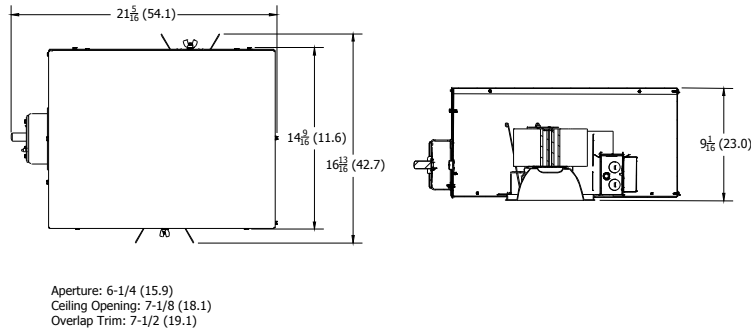

**LDN6 EL**

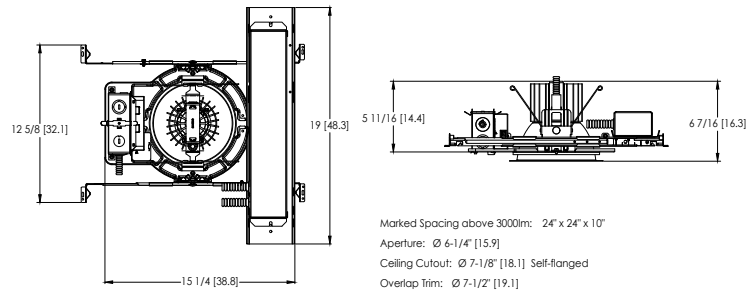

LDN6

L2B

LDN6

ADDITIONAL DATA



The Sensor Switch JOT enabled solution offers a wireless, app-free approach to single room lighting control. JOT enabled products use Bluetooth® Low Energy (BLE) technology to enable wireless dimming and switching.

Diagram



LDN6 Series



Sensor Switch  
WSXA JOT

1. **Power:** Install JOT enabled fixtures and controls as instructed.
2. **Pair:** Insert the pairing tool into the pinhole on the wall switch; press and hold any button for 6 seconds.
3. **Play:** Once paired, each fixture will individually dim down to 10% brightness. All products will be fully functional.

COMPATIBLE 0-10V WALL-MOUNT DIMMERS		
MANUFACTURER	PART NO.	POWER BOOSTER AVAILABLE
Lutron®	Diva® DDTV	
	Diva® DVSCTV	
	Nova™ NTFTV	
	Nova® NFTV	
Leviton®	AWSMT-7DW	CN100
	AWSMG-7DW	PE300
	AMRMG-7DW	
	Leviton Centura Fluorescent Control System	
	IllumaTech® IP7 Series	
Synergy®	ISD BC	RDMFC
	SLD LPCS	
	Digital Equinox (DEQ BC)	
Douglas Lighting Controls	WPC-5721	
Entertainment Technology	Tap Glide TG600FAM120 (120V)	
	Tap Glide Heatsink TGH1500FAM120 (120V)	
	Oasis OA2000FAMU	
Honeywell	EL7315A1019	EL7305A1010 (optional)
	EL7315A1009	
HUNT Dimming	Preset slide: PS-010-IV and PS-010-WH	
	Preset slide: PS-010-3W-IV and PS-010-3W-WH	
	Preset slide, controls FD-010: PS-IFC-010-IV and PS-IFC-010-WH-120/277V	
	Preset slide, controls FD-010: PS-IFC-010-3W-IV and PS-IFC-010-3W-WH-120/277V	
	Remote mounted unit: FD-010	
Lehigh Electronic Products	Solitaire	PBX
PDM Electrical Products	WPC-5721	
Starfield Controls	TR61 with DALI interface port	RT03 DALI.net Router
WattStopper®	LS-4 used with LCD-101 and LCD-103	



LDN6

L2B

**LDN6**

**EXAMPLE**

Group Fixture Control\*

\*Application diagram applies for fixtures with eldoLED drivers only.

- nPS 80 EZ** Dimming/Control Pack (qty: 2 required)
- nPODM 2P DX** Dual On/Off/Dim Push-Button WallPod
- nCM ADCX** Daylight Sensor with Automatic Dimming Control
- nCM PDT 9** Dual Technology Occupancy Sensor

**Description:** This design provides a dual on/off/dim wall station that enables manual control of the fixtures in Row A and Row B separately. Additionally, a daylight harvesting sensor is provided so the lights in Row B can be configured to dim automatically when daylight is available. An occupancy sensor turns off all lights when the space is vacant.

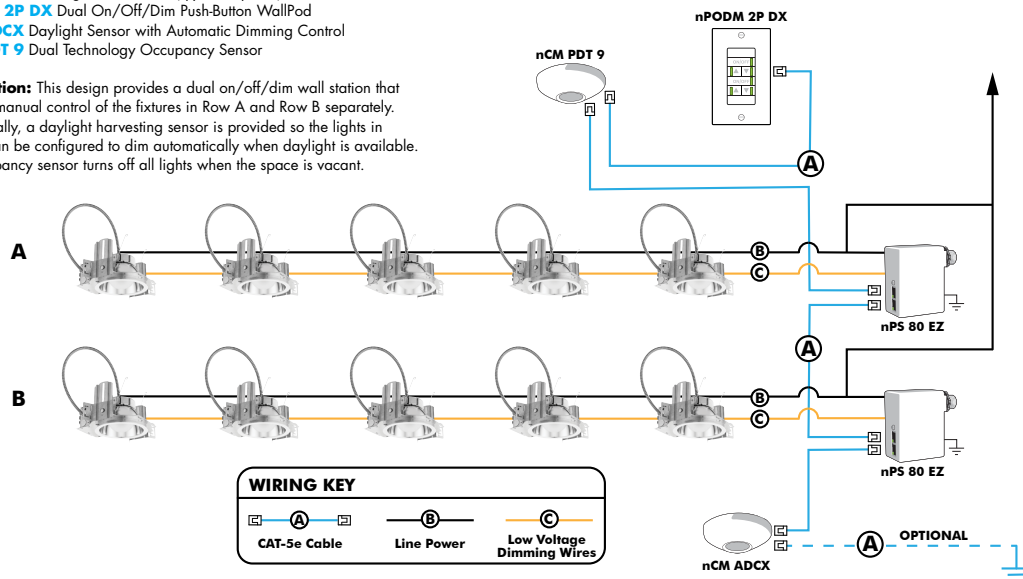

**Choose Wall Controls**

nLight offers multiple styles of wall controls - each with varying features and user experience.



**Push-Button Wallpod**  
Traditional tactile buttons and LED user feedback



**Graphic Wallpod**  
Full color touch screen provides a sophisticated look and feel

**nLight® Wired Controls Accessories:**

Order as separate catalog number. Visit <a href="http://www.acuitybrands.com/products/controls/nlight">www.acuitybrands.com/products/controls/nlight</a> for complete listing of nLight controls.			
WallPod Stations	Model number	Occupancy sensors	Model Number
On/Off	nPODM (Color)	Small motion 360°, ceiling (PIR/dual Tech)	nCM 9 / nCM PDT 9
On/Off & Raise/Lower	nPOD DX (Color)	Large motion 360°, ceiling (PIR/dual tech)	nCM 10 / nCM PDT 10
Graphic Touchscreen	nPOD GFX (Color)	Wide View (PIR/dual tech)	nWV 16 / nWV PDT 16
<b>Photocell controls</b>	<b>Model Number</b>	Wall Switch w/ Raise/Lower (PIR/dual tech)	nWSX LV DX / nWSX PDT LV DX
Dimming	nCM ADCX	<b>Cat-5 cables (plenum rated)</b>	<b>Model Number</b>
		10', CAT5 10FT	CAT5 10FT J1
		15, CAT5 15FT	CAT5 15FT J1



LDN6



L2B

**LDN6**

<b>nLight® AIR Control Accessories:</b> <i>Order as separate catalog number. Visit <a href="http://www.acuitybrands.com/products/controls/nlightair">www.acuitybrands.com/products/controls/nlightair</a>.</i>	
<b>Wall switches</b>	<b>Model number</b>
On/Off single pole	rPODB [color]
On/Off two pole	rPODB 2P [color]
On/Off & raise/lower single pole	rPODB DX [color]
On/Off & raise/lower two pole	rPODB 2P DX [color]
On/Off & raise/lower single pole	rPODBZ DX WH <sup>1</sup>

**UL924 Sequence of Operation**

- The below information applies to all nLight AIR devices with an EM option.
- EM devices will remain at their high-end trim and ignore wireless lighting control commands, unless a normal-power-sensed (NPS) broadcast is received at least every 8 seconds.
  - Using the CLAIRITY+ mobile app, EM devices must be associated with a group that includes a normal power sensing device to receive NPS broadcasts.
  - Only non-emergency rPP20, rLSXR, rSBOR, rSDGR, and nLight AIR luminaires with version 3.4 or later firmware can provide normal power sensing for EM devices. See specification sheets for control devices and luminaires for more information on options that support normal power sensing.

**Notes**

- Can only be ordered with the RES7Z zone control sensor version.

**nLight AIR**

nLight AIR is the ideal solution for retrofit or new construction spaces where adding communication is cost prohibitive. The integrated nLight AIR rPP20 Power Pack is part of each Lithonia LDN Luminaire. These individually addressable controls offer the ultimate in flexibility during initial setup and for space repurposing.



**Simple as 1,2,3**

1. Install the nLight® AIR fixtures with embedded smart sensor
2. Install the wireless battery-powered wall switch
3. With CLAIRITY app, pair the fixtures with the wall switch and if desired, customize the sensor settings for the desired outcome



LDN6



lightly

glow (direct) | specification sheet 2023

lightly | glow  
direct

L3

project: \_\_\_\_\_  
type: \_\_\_\_\_  
date: \_\_\_\_\_ qty: \_\_\_\_\_

### features

- Suspended direct LED luminaire
- Carbon-conscious: designed with natural, renewable, non-toxic components. Red-list free. Fixture housing contains no metal, plastic, or glass
- Internal reflector conceals LEDs, and offers a lambertian distribution without pixels or shadows
- Lightweight wood and wool construction reduces the embodied carbon and cost of shipping as compared to traditional metal fixtures
- Excellent choice for projects with sustainability and embodied carbon requirements; net-zero, LEED, WELL v2

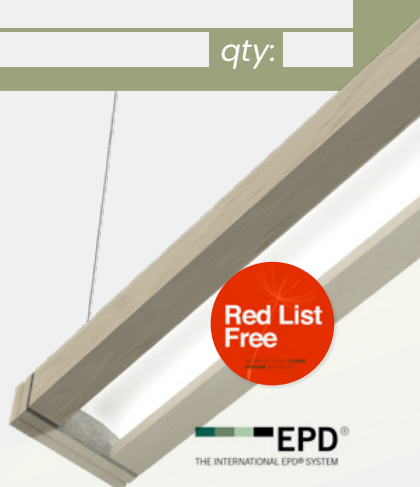

### dimensional data

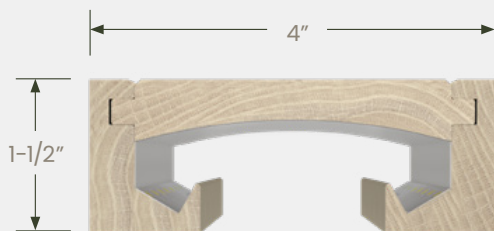

**height:** 1-1/2"  
**width:** 4"  
**weight:** (\*8' Fixture) 6lbs.  
**length:** 2' minimum, no maximum run length (\*Custom lengths are available in 3" nominal increments. Submittals will be created)

### performance

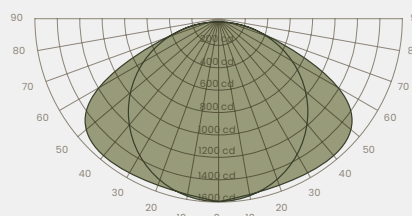

**lumen output:** 250-750 lm/ft  
**LPW:** 93-94  
**wattage:** 2.6-7.8 w/ft  
**SDCM:** 3

### specifications

#### LED systems

Premium LEDs on a robust platform to achieve excellent thermal management. Available in 3000K, 3500K, 4000K with CRI>90. Also available in tunable white, ranging from 2700-6500K with CRI-90.

#### construction

Carefully curated materials to ensure reliable, durable construction with sustainability at the forefront. Sustainably harvested Pennsylvania poplar housing and end caps, 100% natural wool felt gaskets, non-toxic wood adhesive, and VoC-free wood stains. An 8' fixture weighs 6 lbs.

#### finish

Non-toxic, bioderived wood finishes, pigmented stains, semi-opaque pigmented paint, or highly opaque paint are used to achieve our natural, honey, dark walnut, black, and white finishes. See pg. 5 for more details.

#### optic

lightly Glow Direct challenges traditional luminaire design, typically reliant on translucent diffusers to distribute light. Instead, it delivers a 100% direct distribution with a distinctive glowing arch optical profile finished in highly reflective matte white eco-friendly paint. The LED engines are concealed from viewing from all sides, reducing glare and creating a comfortable lighting experience.

#### labels

Our highly sustainable fixtures have Declare and EPD labels and certifications and are UL Dry, indoor use only.

#### electrical

All luminaires provided with remote drivers only. Standard 120-277 VAC constant current driver includes 0-10V analog dimming. Power factor > .95. Refer to pg. 8 for maximum run length from fixture to driver.

#### emergency

If emergency battery (B) is specified, the luminaire will be provided with a factory installed LED emergency lighting battery pack for both normal and emergency operation, 120-277 VAC only. Emergency mode provides constant power to a nominal 10W LED load for a period of 90 minutes. The unit contains a long-life Li-Ion battery and inverter circuitry and will come prewired in the remote driver box. Charge indicator light and test switch provided with mounting options to canopy or driver box. Refer to Lightly installation documentation for more details. Emergency circuiting (C) provided as a separate GTD unit (generator transfer device) to be mounted remotely in the field by others. The GTD works in conjunction with an auxiliary generator or a central inverter system to power the fixture for emergency egress lighting regardless of fixture wall switch position. Refer to Lightly installation documentation for more details.

#### lumen maintenance

Tested in accordance with LM-80. Reported L70>60,000 hrs (105 C).

#### reliability

At Lightly, our products are designed to stand the test of time, then be recycled, repurposed, or biodegraded at end of life. To ensure longevity, all products must pass rigorous testing in environmental chambers evaluating the potential for warping and humidity absorption.

T (215)-422-3988 | [lightly.com](http://lightly.com)  
Lightly reserves the right to modify product specifications without notification.  
©Lightly All rights reserved. April 2023

page 2 of 10  
Version 1.1

Part #10-0042



L3

project: \_\_\_\_\_  
type: \_\_\_\_\_  
date: \_\_\_\_\_ qty: \_\_\_\_\_

## ordering guide

1	2	3	4	5	6	7	8	9	10	11	12	13

1: SERIES	2: TYPE	3: NOMINAL LENGTH (ft.)	4: WOOD FINISH	5: END CAP FINISH	6: WOOL FELT COLOR
<b>G</b> glow	<b>D</b> direct	<b>2'0</b> <b>8'0</b> <b>4'0</b> X'X (custom) <b>6'0</b> <small>*3" nominal increments</small>	<b>W</b> white <b>B</b> black <b>N</b> natural <b>H</b> honey <b>D</b> dark walnut	<b>W</b> white <b>B</b> black <b>N</b> natural <b>H</b> honey <b>D</b> dark walnut	<b>T</b> thunderstorm <b>G</b> graphite <b>H</b> heather gray <b>F</b> fern green
7: MOUNTING	8: LIGHT OUTPUT (lm/ft.)	9: CCT (90 CRI)	10: DRIVER	11: WIRING & EMERGENCY	12: CONTROLS
<b>A</b> aircraft cable suspension	<b>L</b> 250 (2.6w/ft) <b>M</b> 500 (5.1w/ft) <b>H</b> 750 (7.8w/ft)	<b>30</b> 3000K <b>35</b> 3500K <b>40</b> 4000K <b>TW</b> 2700-6500K	<b>R</b> 0-10 V Dim 1.0% 120-277 V	<b>B_*</b> emerg. battery <b>C</b> emerg. circuit <b>Z</b> not applicable <small>*for continuous runs, specify the number of units with emergency battery capability (ex. B2)</small>	<b>_</b> (blank)

**13: OPTIONS**

**Driver Box Faceplate**

**W** white wood  
**B** black wood  
**N** natural wood  
**H** honey wood  
**D** dark walnut  
**Z** standard (paintable steel)  
\*driver box is e-coat white steel, see install guide for dimensions and details

## performance chart

config.	delivered lumens (lm/ft)		
	direct	power (w/ft)	efficacy (lm/w)
low	250	2.6	94
med	500	5.1	94
high	750	7.8	93

performance specifications are nominal



L3

project: \_\_\_\_\_  
type: \_\_\_\_\_  
date: \_\_\_\_\_ qty: \_\_\_\_\_

### sustainable in every way

Bill of Material Weight - 8 ft. Standalone

**dowels**  
material: beech  
total weight: 0.02 lbs

**wool felt gaskets**  
material: wool felt  
total weight: 0.05 lbs

**LED boards**  
materials:  
copper  
polyimide  
tin  
(see Declare label  
for full list)  
total weight: 0.2 lbs

**wood profiles**  
material: poplar  
total weight: 5.70 lbs

**power cord**  
material: non-PVC  
total weight: .8 lbs

*miscellaneous:*  
**non-toxic paint**  
total weight: 0.01 lbs

**non-toxic glue**  
total weight: 0.01 lbs

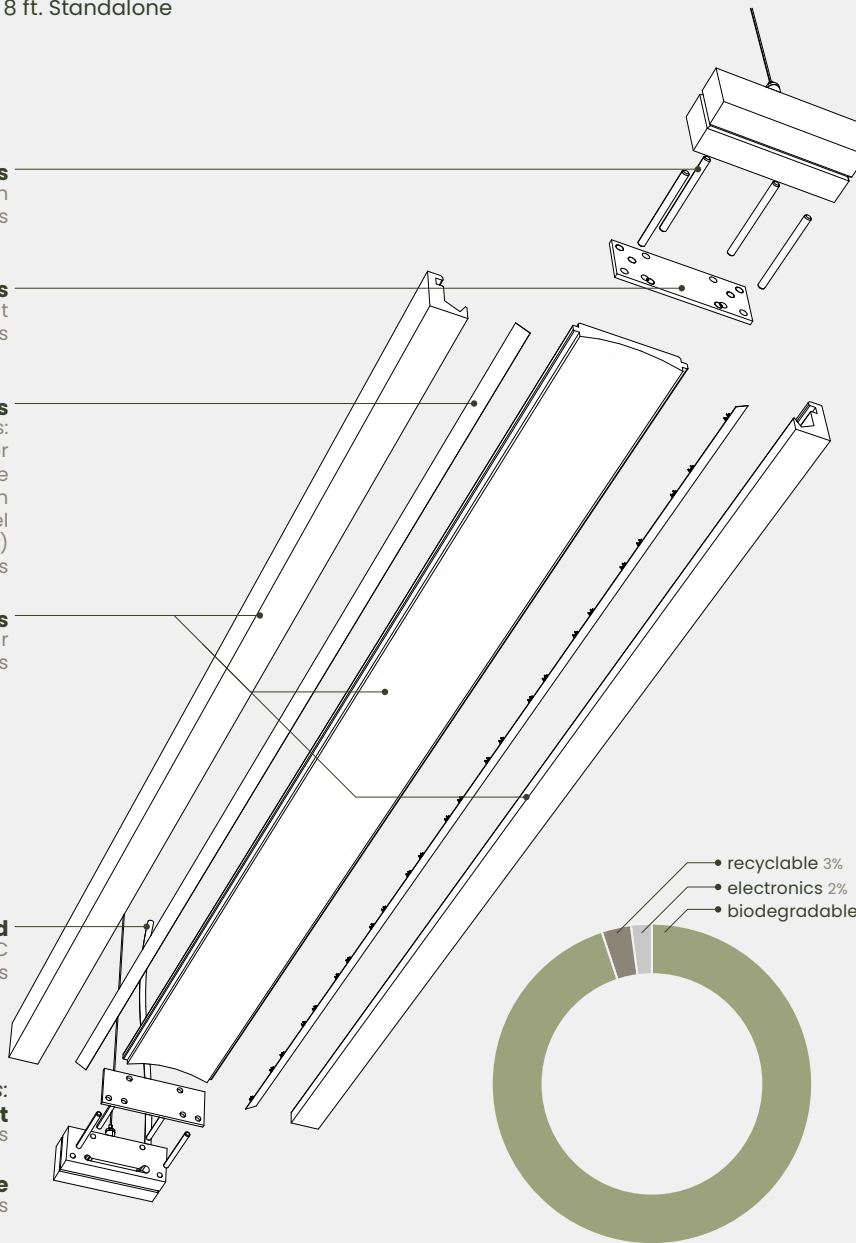



L3 project:   
type:   
date:  qty:

## finish key

lightly offers variations of finishes for components including wood color & wool felt color

### wood finish

**W**  
white paint

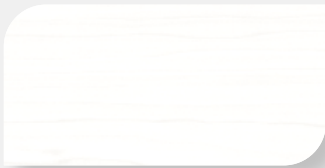

**N**  
natural



**H**  
honey



**D**  
dark walnut



**B**  
black stain

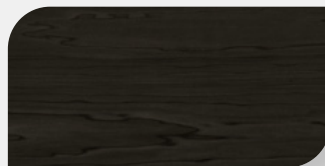

\*Wood is a natural material and is therefore subject to small variations in tone, texture, and grain. The swatch palettes for *Natural*, *Honey* and *Dark Walnut* represent a possible range of finishes.

### wool finish

**T**  
thunderstorm

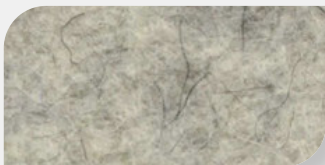

**G**  
graphite

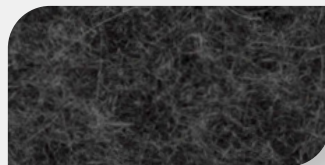

**H**  
heather gray

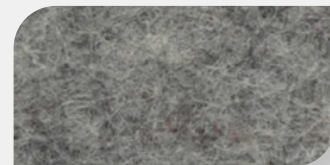

**F**  
fern green





L3

project:   
type:   
date:  qty:

### our glow finishes

lightly offers a range of gorgeous natural materials that sequester carbon, harvested from fast growth sources that don't deplete precious natural resources.



natural finish with  
heather gray felt



**white**  
showing thunderstorm wool felt



**black**  
showing graphite wool felt

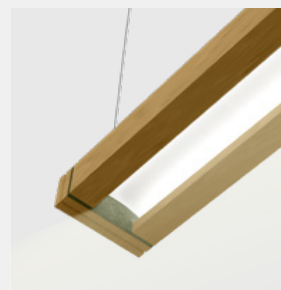

**honey**  
showing fern green wool felt



**dark walnut**  
showing fern green wool felt



L3

project: \_\_\_\_\_  
 type: \_\_\_\_\_  
 date: \_\_\_\_\_ qty: \_\_\_\_\_

## configuration

lightly glow has been designed for easy on-site installation and uniform runs

### standard run configurations

The table below shows how the standard run lengths are configured. For other run lengths or layouts, contact customer support.

nominal run length	section lengths	nominal run length	section lengths
2'	2'	16'	8'+8'
4'	4'	20'	8'+8'+4'
6'	6'	24'	8'+8'+8'
8'	8'	28'	8'+8'+8'+4'
12'	6'+6'	32'	8'+8'+8'+8'

### nominal length vs. actual length

The nominal length of each section of a run is equal to the on-center spacing of the suspension points.

The actual length of the overall run is 3/4" longer at each end than the nominal length of the overall run.

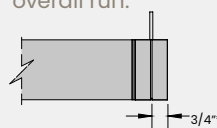

\* ▼ indicates standard power drop locations

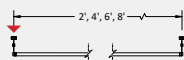

2 ft, 4 ft, 6 ft, 8 ft

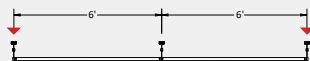

12 ft

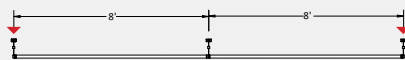

16 ft

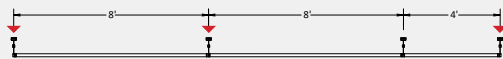

20 ft

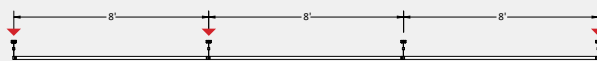

24 ft

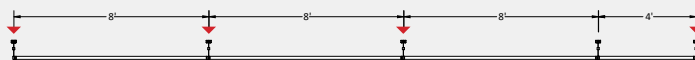

28 ft

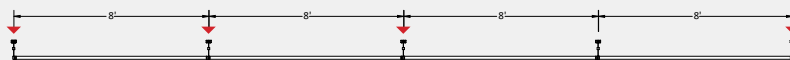

32 ft

### natural wood deviations

Lightly maintains a straightness tolerance of  $\pm 1/16"$  on standalone units and  $\pm 1/8"$  on continuous units. Fixtures are intended for indoor use only and must be stored and installed in a climate controlled area to remain within specified limits.



T (215)-422-3988 | lightly.com  
 Lightly reserves the right to modify product specifications without notification.  
 ©Lightly All rights reserved. April 2023

page 7 of 10  
 Version 1.1

Part #10-0042





L3

project:   
 type:   
 date:  qty:

## profile & optical distribution

Hidden light sources and a reflective arch deliver low-glare illumination

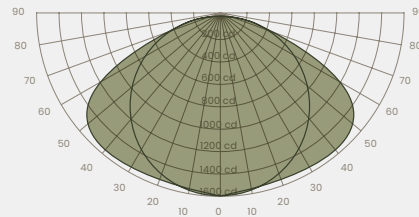
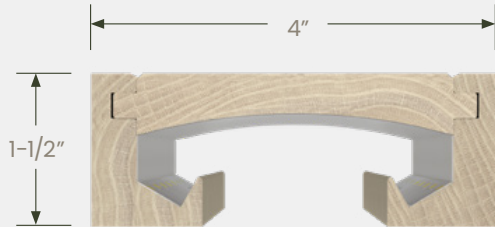

## optical distribution

100% direct optical distribution. The fixture utilizes two light sources aimed at an arch finished in highly reflective eco-friendly paint to deliver a low-glare glowing illumination without needing plastic diffusers.

## photometrics

uncompromised performance in a variety of color temperature and lumen outputs.

configuration	delivered lumens (lm/ft)		
	direct	power (W/ft)	efficacy (lm/W)
low	250	2.6	94
med	500	5.1	94
high	750	7.8	93

## remote mounting of drivers

Wire size (max distance from canopy to drivers)

20 AWG - 50'

18 AWG - 80'

16 AWG - 125'

14 AWG - 200'

\*Drivers must be accessible after installation.

\*One driver per 8' section

\*Option for gang of drivers in a remote location.



L3

project:   
type:   
date:  qty:

## transparent to the core

### wood sourcing

The wood is sourced sustainably in compliance with AHEC (American Hardwood Export Council) regulations from the State of Pennsylvania and has the optional ability to be provided with FSC certified chain of custody.

### wood processing

The wood frame is furniture-grade dried wood at 7-8% moisture content, tested to numerous QC standards to ensure its minimum stress, the right humidity uniformity, and exceeds the grading standards for FAS Lumber. The wood is processed via continuous moulding cutting processes to ensure consistent characteristics. The wood end caps are made from matching wood formed via a precision CNC milling process.

### wood housing

The primary body consists of a continuous wood perimeter frame with wood endcaps and an open optical reflector cavity finished in high reflectance bright white.

### wood finishes

Wood body and endcap finish options include non-toxic, bioderived wood finishes, pigmented stains, semi-opaque pigmented paint, or highly opaque paint. All paint options and reflective surfaces utilize air-purifying paint which neutralizes chemicals, pollutants, and VOCs for improved indoor air quality.

### natural wood glue

Gelatin glue and jelly glue are the modern terms for protein-based adhesives. Additional ingredients include water, Epsom salts, corn sugar, and glycerin. Non-toxic, recyclable and eco-friendly.

### wool felt pad

Biodegradable, naturally dyed, 100% wool. Creates distinctive contrasting design feature while preventing any light leakage at end cap joint.

### LED engine

Flexible PCB with mid-power LED packages adhered to fixture body in continuous rows. LED engine can be easily stripped from fixture at end of life without removing any fasteners.

### power supply

Remote driver solution with multiple mounting options.

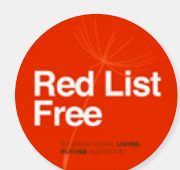
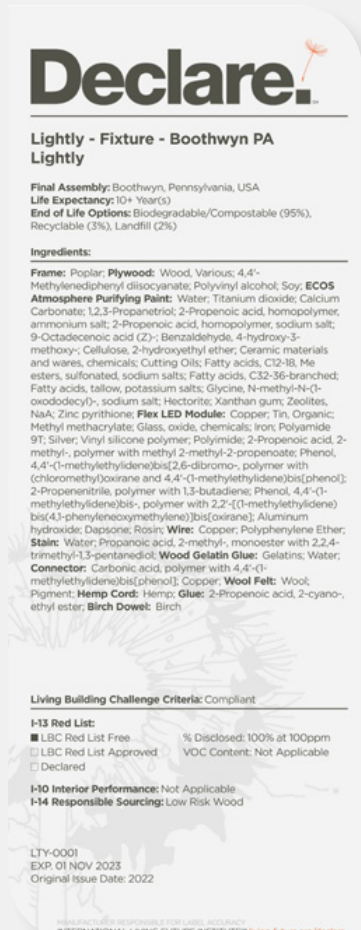

T (215)-422-3988 | [lightly.com](http://lightly.com)  
Lightly reserves the right to modify product specifications without notification.  
©Lightly All rights reserved. April 2023

page 9 of 10  
Version 1.1

Part #10-0042





# HPCS2

Silhouette Static White Ceiling Mount

SPECIFICATIONS

Type: **L4**  
Project:

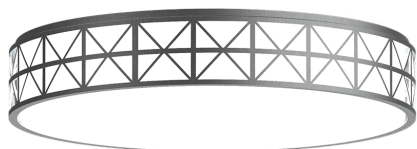

### HIGHLIGHTS

- 12", 18", 24", 36", and 48" diameter sizes
- Up to 1000 lumens in 12" diameter and 10500 lumens in 48" diameter
- Five distinct trim patterns
- Four static white color temperatures in two CRI options
- nLight® enabled system networking
- 0-10v dimming or Lutron® dimming option
- Remote emergency battery pack
- Available in (13) standard powder paint colors, (1) metal finish, and RAL or custom color possibilities
- Total System Integration features a 5-year limited warranty by Acuity Brands covering all components and construction

### CONFIGURATION

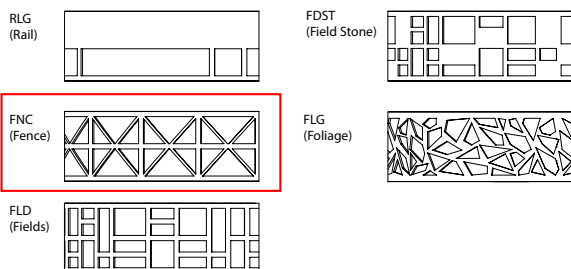

### DIMENSIONS

\*Reference Drawing Detail section for additional information

#### HPCS2 FLSH (FLUSH LENS)

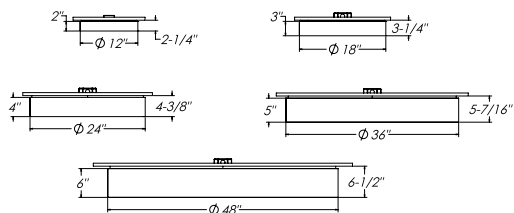

### LUMEN OUTPUT

\*\* Performance data based upon FLSH (Flush Lens) / FNC (Fence Pattern) / 35K/ 80CRI

	12DIA	18DIA	24DIA	36DIA	48DIA
Nominal Lumens	1000LM	1800LM	3400LM	6000LM	10500LM
Delivered Lumens	1358	2073	3329	6993	11588
Input Watts	11.43	20.90	34.19	71.41	110.67
Lumens/Watt	118.81	99.19	97.37	96.58	104.71

(Reference Performance Data section for additional lumen outputs.)

### COMPANION LUMINAIRE(S)

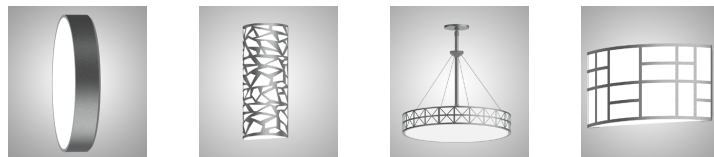

**HPSS** Silhouette LED Solid Round Sconce  
**HPSS2 FLG** Silhouette LED Pattern Vertical Sconce  
**HPSS2 FNC** Silhouette LED Pattern Pendant  
**HPSS3 FLD** Silhouette LED Pattern Horizontal Sconce

AcuityBrands Healthcare Lighting • (888) 834-5684 • www.healthcare-lighting.com

© 2020-2023 Acuity Brands Lighting, Inc. All Rights Reserved. "Healthcare Lighting" is a registered trademark of Acuity Brands Lighting. Products herein may be covered by one or more U.S. Patents and Patents Pending. Specifications subject to change without notice.

Rev. 06/05/23  
HPCS2\_STWH 1



**HPCS2**

Silhouette Static White Ceiling Mount

L4

Type:  
Project:

A+ Capable options indicated by this color background.

**CATALOG NUMBER**

Example: HPCS2 24DIA MVOLT FLSH 2400LM 40K 80CRI FNC NLIGHT DARK OGP

Series	Size	Voltage	Lens	Lumen Output	LED Color Temperature	LED Color Rendering
HPCS2 Silhouette Decorative Pattern Ceiling Mount	<b>12DIA</b> 12" Diameter <b>18DIA</b> 18" Diameter <b>24DIA</b> 24" Diameter <b>36DIA</b> 36" Diameter <b>48DIA</b> 48" Diameter	<b>MVOLT</b> 120-277 Volt <b>120*</b> 120V <b>277*</b> 277V <b>347**</b> 347V *Reference Remote Driver section for when voltage must be specified **Available with MIN1 and ZT only **Not available in 36DIA w/ 6000LM or 48DIA w/ 8500LM thru 10500LM	FLSH Flush Lens	(Values shown represent the min and max range. Reference Performance Data section for full listing.) For 12DIA use: <b>600LM*</b> 1000LM For 18DIA use: 1100LM 1800LM For 24DIA use: 2000LM 3400LM For 36DIA use: 3500LM 6000LM For 48DIA use: <b>6000LM</b> 10500LM *Not available w/ ECOD	27K 2700K <b>30K</b> 3000K <b>35K</b> 3500K 40K 4000K	<b>80CRI</b> 80CRI 90CRI 90CRI

Configuration	Control Input	Minimum Dimming Level	Emergency	Finish
RLG Rail <b>FNC</b> Fence FLD Fields FDST Field Stones FLG Foliage	<b>ZT</b> 0-10V NLIGHT nLight Enabled ECOD* Lutron Hi-Lume EcoSystem Digital LED Driver, 1% dimming *Available w/ 277 only in 48DIA	DARK Constant Current, Dimming to <1% MIN1 Constant Current, Dimming to 1%	E10W.LCP* 10w Battery Pack, Constant Power w Self Diagnostic, T20 Compliant (remote) EMG** Emergency nLight Device for Use w Generator Supply EM Power *Not available w/ 347 **Available w/ NLIGHT only	BA Brushed Aluminum ALP Aluminum Paint (Matte) BGP Black Gloss Paint BKT Black Textured Paint GGP Green Gloss Paint GW Gloss Paint White LBGW Light Blue Gloss Paint MBGP Medium Blue Gloss Paint MBP Medium Bronze Metallic Gloss Paint MGG Medium Green Gloss Paint OGP Orange Gloss Paint RGP Red Gloss Paint WHT White Textured Paint YGP Yellow Gloss Paint SGB Semi-Gloss Black GWAM Gloss White Antimicrobial MWAM Matte White Antimicrobial BZAM Bronze Antimicrobial

**ARCHITECT TO SELECT FINAL FINISH**



L4  
HPCS2

Silhouette Static White Ceiling Mount

Type:

Project:

## SPECIFICATIONS

### Housing

Rolled and welded smooth aluminum extruded housing with hydro cut pattern trim detail.

### Lens

Matte opal acrylic fabricated drum shape flush lens.

### Finish

Color for housing and backplate. Available in thirteen polyester powder paint solid colors and one metal finish. Consult factory for custom colors or specify RAL colors from Architectural brochure.

### Mounting

Mount directly to a standard junction box (by others). For fixtures over 40 lbs, additional support to structure (by others) required..

### Source

Multiple LED lumen packages provided with four available color temperature options (2700K, 3000K, 3500K, and 4000K) all within 2.5 MacAdam ellipses.

### Circuiting

Offered in single circuit with emergency circuits or nLight options.

### Emergency Battery

Remote battery enclosure for battery operation of 90 minutes. Remote test switch and indicator light provided with wall/ceiling plate. Reference chart in the Remote Drivers section for calculating delivered lumens in emergency mode.

### Controls and System Networking Options

Wired networking via Cat-5e (by others).

### Remote Dimming Driver

eldoLED® driver provides smooth, continuous and flicker-free dimming to dark <1% THD; < 20%. Insignificant inrush current at 120 and 277VAC. FCC Class A and B tested for EMI and RFI. Driver will be set for Linear dimming curve.

### LED Life

LED light engine — consisting of modular LED boards — is rated for 60,000 hours (L80) at 25° C ambient temperature.

### Environment

Suitable for dry or damp location.

### Certification

CSA Certified to meet U.S. and Canadian standards conforming to UL 1598 and CAN/CSA C22.2 No. 250.0

### Compliance

Buy American Act compliant.

### Buy American Act

This product is assembled in the USA and meets the Buy America(n) government procurement requirements under FAR, DFARS and DOT regulations. Please refer to [www.acuitybrands.com/resources/buy-american](http://www.acuitybrands.com/resources/buy-american) for additional information

### Warranty

5-year limited warranty. This is the only warranty provided and no other statements in this specification sheet create any warranty of any kind. All other express and implied warranties are disclaimed. Complete warranty terms located at: [www.acuitybrands.com/support/warranty/terms-and-conditions](http://www.acuitybrands.com/support/warranty/terms-and-conditions)

**Note:** Actual performance may differ as a result of end-user environment and application. All values are design or typical values, measured under laboratory conditions at 25°C.

### A+ Capable Luminaire

This item is an A+ capable luminaire, which has been designed and tested to provide consistent color appearance and out-of-the-box control compatibility with simple commissioning.

- All configurations of this luminaire meet the Acuity Brands' specification for chromatic consistency
- This luminaire is part of an A+ Certified solution for nLight® control networks when ordered with drivers marked by a shaded background\*
- This luminaire is part of an A+ Certified solution for nLight control networks, providing advanced control functionality at the luminaire level, when selection includes driver and control options marked by a shaded background\*

To learn more about A+, visit [www.acuitybrands.com/aplus](http://www.acuitybrands.com/aplus).

\*See ordering tree for details



**HPCS2**  
Silhouette Static White Ceiling Mount

L4

Type:  
Project:

**DIMENSIONS**

**HPCS2 FLSH (Flush Lens)**

\* Reference Installation Instructions for mount hole locations

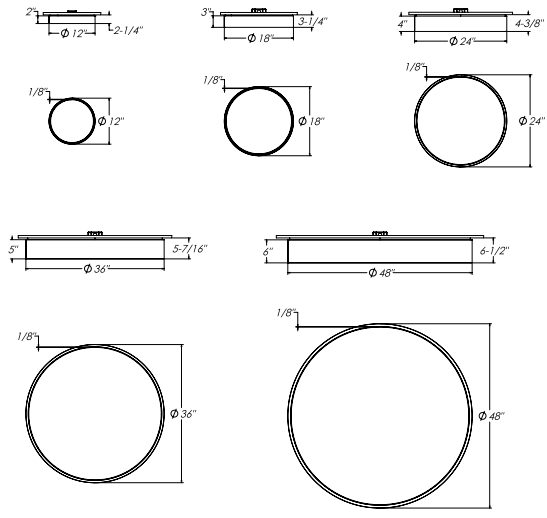

L4



HPCS2

Silhouette Static White Ceiling Mount

Type:  
Project:

PERFORMANCE DATA

\*\* Performance data based upon FLSH (Flush Lens) / FNC (Fence Pattern) / 35K/ 80CRI

Diameter	Direct Nominal Lumens	Delivered Lumens	Input Watts	Lumen/Watt
12DIA	600LM	813	5.88	138.27
	800LM	1086	8.67	125.26
	1000LM	1358	11.43	118.81
18DIA	1100LM	1265	11.89	106.39
	1450LM	1669	16.4	101.77
	1800LM	2073	20.9	99.19
24DIA	2000LM	1896	17.73	106.94
	2200LM	2101	20.09	104.58
	2400LM	2306	22.44	102.76
	2600LM	2510	24.79	101.25
	2800LM	2715	27.14	100.04
	3000LM	2920	29.49	99.02
	3200LM	3124	31.84	98.12
	3400LM	3329	34.19	97.37

Diameter	Direct Nominal Lumens	Delivered Lumens	Input Watts	Lumen/Watt
36DIA	3500LM	3720	33.71	110.35
	4000LM	4374	413.45	10.58
	4500LM	5029	49.19	102.24
	5000LM	5684	56.93	99.84
	5500LM	6339	64.67	98.02
	6000LM	6993	72.41	96.58
48DIA	6000LM	5796	72.41	80.04
	6500LM	6440	56.56	113.86
	7000LM	7083	63.33	111.84
	7500LM	7727	70.09	110.24
	8000LM	8370	76.86	108.90
	8500LM	9014	83.62	107.80
	9000LM	9657	90.38	106.85
	9500LM	10301	97.15	106.03
	10000LM	10945	103.91	105.33
	10500LM	11588	110.67	104.71

Lumen Multiplier Table for CCT and CRI

Data table baseline is 3500K 80CRI photometry. This table can be used to approximate the lumen values at different Kelvin temperatures and Color Rendering Index. Power consumption would stay the same.

CCT	CRI	Multiplier
27K	80	0.941
30K	80	1.000
35K	80	1.000
40K	80	1.029
27K	90	0.794
30K	90	0.853
35K	90	0.853
40K	90	0.882

Lumen Multiplier Table for Trim

Data table baseline is FNC 3500K 80CRI photometry. This table can be used to approximate the lumen values at different housing trim. Power consumption would stay the same.

Trim	Lens	Multiplier
FNC	FLSH	1.000
RLG	FLSH	0.894
FLD	FLSH	0.967
FDST	FLSH	0.919
FLG	FLSH	0.916



L4



HPCS2

Silhouette Static White Ceiling Mount

Type:  
Project:

REMOTE DRIVERS

\*Always required for ceiling mount fixture

Remote	Non-IC Rated (MVOLT no longer applicable. Specific Voltage 277 only available & must be specified)
Remote	Non-IC Rated (MVOLT no longer applicable. Specific Voltage 120 or 277 must be specified)
—	Not Available Combination
Remote (S)	Remote Single Driver Box (1 box w/ 1 driver)
Remote (D)	Remote Double Driver Box (1 box w/ 2 drivers)

Driver Matrix - STATIC WHITE				Direct Nominal Lumens		
Diameter	Min Dim Level	Control Input	Voltage	600LM	800LM	1000LM
12DIA	MIN1	ZT	MVOLT	Remote (S)	Remote (S)	Remote (S)
			347	Remote (S)	Remote (S)	Remote (S)
		MLIGHT	Remote (S)	Remote (S)	Remote (S)	
	DARK	ECOD	MVOLT	—	Remote (S)	Remote (S)
		ZT	MVOLT	Remote (S)	Remote (S)	Remote (S)
		MLIGHT	MVOLT	Remote (S)	Remote (S)	Remote (S)

Driver Matrix - STATIC WHITE				Direct Nominal Lumens		
Diameter	Min Dim Level	Control Input	Voltage	1100LM	1450LM	1800LM
18DIA	MIN1	ZT	MVOLT	Remote (S)	Remote (S)	Remote (S)
			347	Remote (S)	Remote (S)	Remote (S)
		MLIGHT	MVOLT	Remote (S)	Remote (S)	Remote (S)
	DARK	ECOD	MVOLT	Remote (S)	Remote (S)	Remote (S)
		ZT	MVOLT	Remote (S)	Remote (S)	Remote (S)
		MLIGHT	MVOLT	Remote (S)	Remote (S)	Remote (S)

Driver Matrix - STATIC WHITE				Direct Nominal Lumens							
Diameter	Min Dim Level	Control Input	Voltage	2000LM	2200LM	2400LM	2600LM	2800LM	3000LM	3200LM	3400LM
24DIA	MIN1	ZT	MVOLT	Remote (S)	Remote (S)	Remote (S)	Remote (S)	Remote (S)	Remote (S)	Remote (S)	Remote (S)
			347	Remote (S)	Remote (S)	Remote (S)	Remote (S)	Remote (S)	Remote (S)	Remote (S)	
		MLIGHT	MVOLT	Remote (S)	Remote (S)	Remote (S)	Remote (S)	Remote (S)	Remote (S)	Remote (S)	Remote (S)
	DARK	ECOD	MVOLT	Remote (S)	Remote (S)	Remote (S)	Remote (S)	Remote (S)	Remote (S)	Remote (S)	Remote (S)
		ZT	MVOLT	Remote (S)	Remote (S)	Remote (S)	Remote (S)	Remote (S)	Remote (S)	Remote (S)	Remote (S)
		MLIGHT	MVOLT	Remote (S)	Remote (S)	Remote (S)	Remote (S)	Remote (S)	Remote (S)	Remote (S)	Remote (S)

Driver Matrix - STATIC WHITE				Direct Nominal Lumens					
Diameter	Min Dim Level	Control Input	Voltage	3500LM	4000LM	4500LM	5000LM	5500LM	6000LM
36DIA	MIN1	ZT	MVOLT	Remote (S)	Remote (S)	Remote (S)	Remote (S)	Remote (D)	Remote (D)
			347	Remote (S)	Remote (S)	Remote (S)	Remote (S)	Remote (S)	—
		MLIGHT	MVOLT	Remote (S)	Remote (S)	Remote (S)	Remote (S)	Remote (D)	Remote (D)
	DARK	ECOD	MVOLT	Remote (S)	Remote (S)	Remote (D)	Remote (D)	Remote (D)	Remote (D)
		ZT	MVOLT	Remote (S)	Remote (S)	Remote (S)	Remote (S)	Remote (D)	Remote (D)
		MLIGHT	MVOLT	Remote (S)	Remote (S)	Remote (S)	Remote (S)	Remote (D)	Remote (D)

Driver Matrix - STATIC WHITE				Direct Nominal Lumens										
Diameter	Min Dim Level	Control Input	Voltage	6000LM	6500LM	7000LM	7500LM	8000LM	8500LM	9000LM	9500LM	10000LM	10500LM	
48DIA	MIN1	ZT	MVOLT	Remote (S)	Remote (S)	Remote (D)	Remote (D)	Remote (D)	Remote (D)	Remote (D)	Remote (D)	Remote (D)	Remote (D)	
			347	Remote (S)	Remote (S)	Remote (S)	Remote (D)	Remote (D)	Remote (D)	—	—	—	—	
		MLIGHT	MVOLT	Remote (S)	Remote (S)	Remote (D)	Remote (D)	Remote (D)	Remote (D)	Remote (D)	Remote (D)	Remote (D)	Remote (D)	
	DARK	ECOD	MVOLT	Remote (S)	Remote (S)	Remote (S)	Remote (D)	Remote (D)	Remote (D)	Remote (D)	Remote (D)	Remote (D)	Remote (D)	
		ZT	MVOLT	Remote (S)	Remote (S)	Remote (D)	Remote (D)	Remote (D)	Remote (D)	Remote (D)	Remote (D)	Remote (D)	Remote (D)	
		MLIGHT	MVOLT	Remote (S)	Remote (S)	Remote (D)	Remote (D)	Remote (D)	Remote (D)	Remote (D)	Remote (D)	Remote (D)	Remote (D)	

L4



HPCS2

Silhouette Static White Ceiling Mount

Type:  
 Project:

REMOTE DRIVERS

Remote Single Driver Box

- \* Reference Installation Instructions for additional details
- \* Maximum remote distance from fixture junction box to driver box is 100-feet

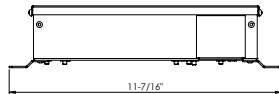
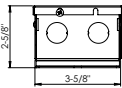
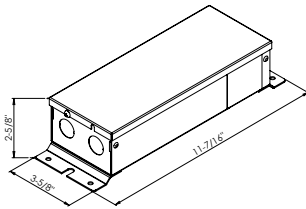

Remote Double Driver Box

- \* Reference Installation Instructions for additional details
- \* Maximum remote distance from fixture junction box to driver box is 100-feet

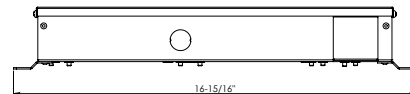
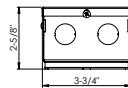
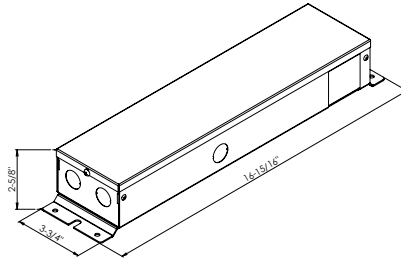

Remote E10WLCP Emergency Box

- \* Reference Installation Instructions for additional details
- \* Maximum remote distance from fixture junction box to driver box is 50-feet (Half distance of driver)

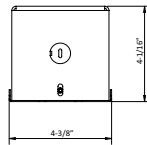
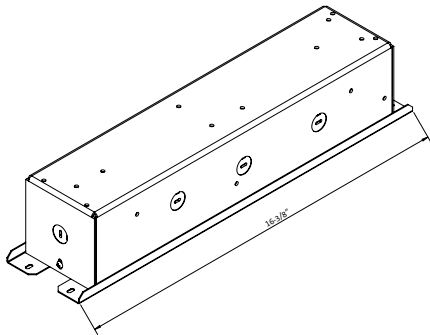

**How to Calculate Delivered Lumens in Emergency Mode**

Use the formula below to determine the delivered lumens in emergency mode

$$\text{Delivered Lumens} = 1.25 \times P \times \text{LPW}$$

P = Output power of emergency driver. P = 10W for E10WLCP option.

LPW = Lumen per watt rating of the luminaire. (LPW information available in Performance Data section.)



## FEATURES & SPECIFICATIONS

**INTENDED USE** — Suitable for architectural applications where aesthetics and superior performance are required.  
**CONSTRUCTION** — High-polish, injection-molded virgin acrylic panel, ultrasonically welded to eliminate visible hardware. Graduated depth of molded letters provides uniform light distribution on graphics. Standard housing finish is brushed aluminum.

Precision-molded, textured letters — 6" high with 3/4" stroke, with 100 ft viewing distance rating, based upon UL924 standard. Chevron indicator direction must be specified.

Recessed rough-in section constructed of 20-gauge, die-formed galvanized steel. Extruded aluminum housing trim mounts flush onto wall or ceiling.

Mounting canopy for top mount is constructed of extruded aluminum housing to match housing finish.

**OPTICS** — LEDs mounted on printed circuit board. The typical life of the exit LED lamp is 10 years.

Low energy consumption — EL N operation: only 2.3W for 120V single-face red sign; 1.7W for 120V single-face green sign. Non-emergency operation: only 1.5W for 120V single-face red sign; 1.2W for 120V single-face green sign.

**ELECTRICAL** — Dual voltage input capability (120/277V).

Sealed, maintenance-free nickel cadmium battery delivers 90 minutes capacity to lamp. Constant-current series charger, 24-hour recharge after 90-minute discharge.

Polarized battery connector simplifies installation and maintenance; prevents charger damage due to improper connection.

**INSTALLATION** — Recessed mount — rough-in section for back, ceiling or end mounting. Fits into minimum wall or ceiling opening 13-5/8" L x 4-1/2" W x 3-1/8" D.

Adjustable T-bar hangers adapt mounting tray for mounting in suspended ceilings or variable-size framed openings. Trim ring has 3/4" variable depth adjustment to ensure flush fit against surface of wall or ceiling.

Plug-in wire connections and self-captive mounting screws for mounting panel/trim to rough-in section.

Top Mount (TM) — low-profile mounting canopy attaches exit to J-box. No rough-in section required.

**LISTINGS** — UL listed. Non-IC recessed mounting. Meets UL 924, NFPA 101 (current Life Safety Code), NEC, FCC Title 47, Part 15, Subpart B and OSHA illumination standards, and State of Minnesota requirements for less than 20W energy consumption.

Catalog Number	
Notes	
Type	X

**PRECISE**  
COLLECTION

Edge-Lit Exits

**LRP**

LED LAMPS



**WARRANTY** — 5-year limited warranty, including lamps. This is the only warranty provided and no other statements in this specification sheet create any warranty of any kind. All other express and implied warranties are disclaimed. Complete warranty terms located at: [www.acuitybrands.com/support/warranty/terms-and-conditions](http://www.acuitybrands.com/support/warranty/terms-and-conditions)

**NOTE:** Actual performance may differ as a result of end-user environment and application. All values are design or typical values, measured under laboratory conditions at 25 °C. Specifications subject to change without notice.

### ORDERING INFORMATION

For shortest lead times, configure products using **bolded options**.

**Example:** LRP 1 RMR LA 120/277 EL N

LRP Family	Housing color	Number of faces	Letters/background	Directional indicators <sup>2</sup>	Input voltage
LRP LED	<b>(blank)</b> Brushed aluminum	<b>1</b> Single face	RW Red on white	<b>(blank)</b> None	<b>120/277</b> Dual voltage
	W White	<b>2</b> Double face	<b>RC</b> Red on clear (single face only)	LA Left <sup>3</sup>	
	B Black		<b>RMR</b> Red on mirror (simulates mirrored background for double-face exits)	RA Right <sup>3</sup>	
	BZ Bronze		GW Green on white	<b>LRA</b> Left and right	
	BS Polished Brass <sup>1</sup>		<b>GC</b> Green on clear (single face only)	<b>DA</b> Double face <sup>4</sup>	
	U Unfinished		<b>GMR</b> Green on mirror (simulates mirrored background for double-face exits)		

Emergency operation	Mounting	Item type	Options <sup>2</sup>
<b>(blank)</b> AC only	<b>(blank)</b> Ceiling or back mount	<b>(blank)</b> Complete exit panel and rough-in section <sup>7</sup>	FI Fire alarm interface <sup>8</sup>
EL N Nickel cadmium battery	EM Recessed end mount	<b>PNL</b> Panel assembly only	F Flashing emergency operation (one flash/second) <sup>9,9</sup>
X2 Lamp boards wired on two separate circuits (specify 120V or 277V) <sup>5</sup>	TM Top mount <sup>6</sup>		

### Accessories: Order as separate items.

ELA R LRIS 120/277 EL N	Single-face, red LED emergency rough-in section <sup>7,10</sup>
ELA G LRIS 120/277 EL N	Single-face, green LED emergency rough-in section <sup>7,10</sup>
ELA R 2LRIS 120/277 EL N	Double-face, red LED emergency rough-in section <sup>7,10</sup>
ELA G 2LRIS 120/277 EL N	Double-face, green LED emergency rough-in section <sup>7,10</sup>
ELA LCRIS	LED rough-in section (supplied standard with recessed exit unless PNL suffix is specified; order ELA LCRIS only if needed for early installation). Available AC only with no options. <sup>10</sup>
ELA LRIS 277 X2	LED rough-in section (supplied standard with recessed exit unless PNL suffix is specified; order ELA LRIS 277 X2 only if needed for early installation). <sup>7,10</sup>
ELA LRIS 120 X2	LED rough-in section (supplied standard with recessed exit unless PNL suffix is specified; order ELA LRIS 120 X2 only if needed for early installation). <sup>7,10</sup>
ELA US12	12" pendant-mount kit (Top mount exits only). Mounting canopy is brushed aluminum. To order white or black canopy, add W or B to catalog number. Example: ELA W US12. To order 24" or 36" lengths, add 24 or 36 to catalog number. Example: ELA US24. See spec sheet <a href="#">ELA-StemKits</a> .

### Notes

- Not available with EM option.
- See chart on back for more information.
- Only available with single face.
- Only available with double face.
- Not available with top mount exits (TM) or EL N operation.
- No Rough-In section required. Attaches directly to J-box. Only available with AC operation.
- When ordering recessed rough-in separately, all options must be included with rough-in nomenclature. Example: ELA LRIS 277 X2 F.
- Choice of F or FI, not available with both. Not available with top mount exits.
- Must select EL N option.
- Rough-in supplied standard with exit unless PNL suffix is specified. Order separately only if needed for early installation.

EMERGENCY

LRP



## LRP Precise® LED Exit Signs

### SPECIFICATIONS

ELECTRICAL EMERGENCY					
Primary Circuit					
Type	Typical LED life <sup>1</sup>	Supply voltage	Number of faces	Input watts	Max. amps
Red	10 years	120	1	2.3	.093
		277	1	2.7	.095
Red	10 years	120	2	3.2	.084
		277	2	3.9	.094
Green	10 years	120	1	1.7	.07
		277	1	1.9	.07
Green	10 years	120	2	3.7	.14
		277	2	3.8	.14

ELECTRICAL AC ONLY					
Primary Circuit					
Type	Typical LED life <sup>1</sup>	Supply voltage	Number of faces	Input watts	Max. amps
Red	10 years	120	1	1.5	.087
		277	1	1.8	.089
		347	1	2.2	.107
Red	10 years	120	2	3.1	.178
		277	2	3.4	.180
		347	2	4.1	.220
Green	10 years	120	1	1.2	.064
		277	1	1.3	.062
Green	10 years	120	2	2.0	.06
		277	2	2.3	.06

BATTERY			
Sealed Nickel-Cadmium (4.8V)			
Typical shelf life <sup>2</sup>	Typical life <sup>2</sup>	Maintenance <sup>3</sup>	Temperature range <sup>4</sup>
3 yrs.	7–9 yrs.	none	32°–100°F (0°–38°C)

#### Notes

- Based on continuous operation. The typical life of the exit LED lamp is 10 years.
- At 77°F (25°C).
- All life safety equipment, including emergency lighting for path of egress must be maintained, serviced, and tested in accordance with all National Fire Protection Association (NFPA) and local codes. Failure to perform the required maintenance, service, or testing could jeopardize the safety of occupants and void all warranties.
- Temperature range where unit will provide capacity for 90 minutes. Higher and lower temperatures affect life and capacity.

### KEY FEATURES

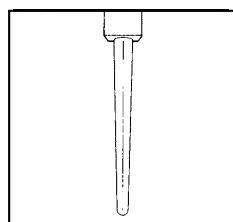

Unique wedge-shaped panel design concentrates light for uniform letter illumination.



Trim fits flush against wall or ceiling for clean, attractive appearance.

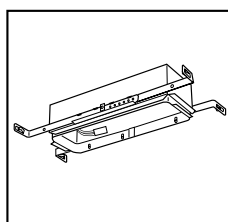

Small rough-in section.  
Emergency operation: contains battery and charger board.  
Non-emergency: rough-in section is empty.

### MOUNTING

All dimensions are in inches (centimeters).

Shipping weight for panel: 5 lbs. (2.3 kgs.)

Shipping weight for rough-in section: 5.8 lbs. (2.6 kgs.)

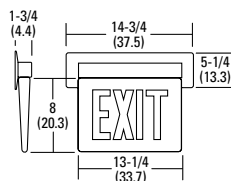

Back Mount (recessed)

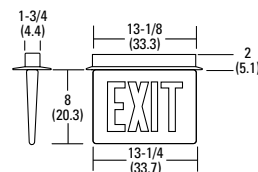

Ceiling Mount (recessed)

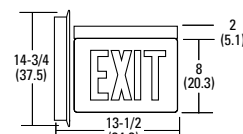

End Mount (recessed)

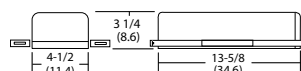

Rough-In Section

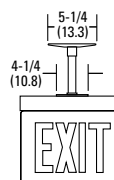

With Pendant Mounting kit (TM mounting only)

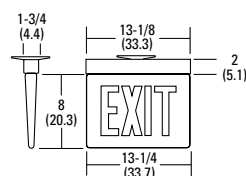

Top Mount (AC only operation)

### Directional Indicators

Specification (add to catalog number)	Graphics	
	Back	Front
LA		
RA		
LRA (single face)		
DA		
LRA (double face)		



LRP

EMERGENCY: One Lithonia Way Conyers, GA 30012 Phone: 800-705-SERV (7378) Email: techsupport-emergency@acuitybrands.com www.lithonia.com

© 1994-2023 Acuity Brands Lighting, Inc. All rights reserved. Rev. 03/14/23